



www.stairservice.com

Sales@stairservice.com

1-800-940-1057

STAINLESS STEEL CHEMICAL COMPOSITION

GRADE	C	Si	Mn	P	S	Ni	Cr	Mo
304	<0.08	<1.00	<2.00	<0.035	<0.035	8.0-10.50	18.00-20.50	18.00-20.50
316	<0.08	<1.00	<2.00	<0.035	<0.035	10.00-14.00	16.00-18.00	16.00-18.00

There are many grades of stainless steel, the majority of stainless steel items in this catalogue are grade 304 & 316.

Grade 304 is the most common stainless steel, and satisfies a broad demand for adequate performance at an affordable price. It has good corrosion resistance in a wide variety of environments, is a best choice for indoor use (except swimming pools, etc.).

Grade 316 has a higher level of corrosion resistance. The Grade 316 is often referred to as “marine grade”. Typical applications are architectural components where they are exposed to extreme weather and climatic conditions, such as near the coast, near industrial sites or in swimming pools.

CORROSION DEFINITION

When stainless steel is produced, the chromium forms an outer oxide layer. As long as this layer remains intact, the stainless steel remains passive. But once the oxide layer begins to break down, the stainless steel becomes active and its corrosion resistance is reduced, and rust will be seen.



STAINLESS STEEL “TEA STAINING”

Stainless steel may suffer from a brown discoloration, or “tea staining” over time. It is visual impairment only, and does not affect the structural integrity or the longevity of the material. The staining occurs most commonly within about 5 kilometers from the sea and becomes progressively worse closer to the marine source. However, wind exposure, pollution and higher temperatures can create environments where tea staining might occur 20 kilometers or more from sea water.

HOW TO DEAL WITH “TEA STAINING”

A) Specify Grade 316 Stainless Steel

Grade 316 is ideal for marine and highly corrosive environments.

B) Choose a smoother surface

The main cause of stain is salt deposited on the stainless steel surface. To reduce the risk of tea staining, choosing or creating a smoother surface of the product is an ideal method.

C) Maintain regularly

Stainless steel is not maintenance free but maintenance friendly. When using steel material outdoors, you need to clean periodically, especially in aggressive environments like coastal areas or swimming pools.

Rain washing regularly will reduce the risk of tea staining. The best way with soap or mild detergent and warm water followed by rinsing with clean cold water. The appearance of the surface can be improved further after wiped dry.

D) Installation and Inspection

After installation, the completed structure should be washed and inspected from imperfection or contaminants caused in the installation process. If discovered, imperfections should be cleaned off and polished with a suitable stainless polish.

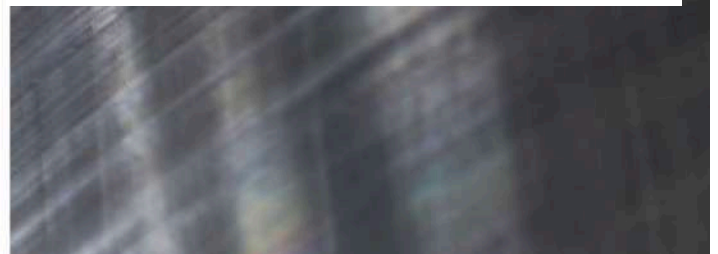

Index

Round Components	4-8
Square Components	9-12
Rectangle Rail	13
Round Channel Rail	14
Cap Trim	15
Wood Rail	16
Wood Rail Fittings	17
Wall Rail Brackets	17-18
Rod and Flat bar Components	19-20
Glass Clamps and mounting accessories	21-22
Aluminum Glass Channel	23
Cable components	24-26
Hardware and Accessories	26-27

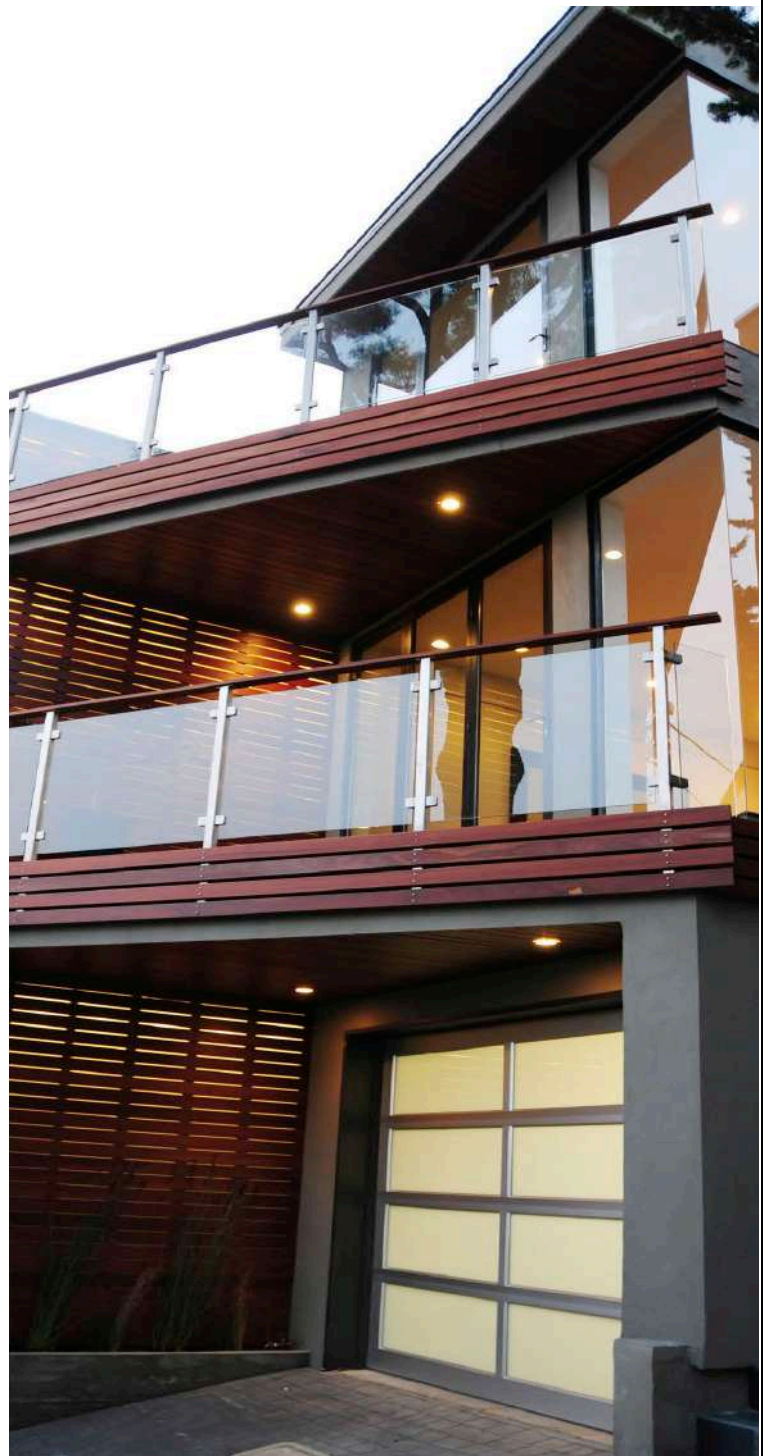

CS	Carbon Steel, will rust if used exterior.
304	Interior grade stainless steel, used mainly for interior applications. May rust if outside for an extended period of time.
316	Exterior grade (marine grade) stainless steel. Mainly used for exterior but can also be used for interior.
2205	Exterior grade (marine grade) stainless steel. Double the Strength of 316. Only a few products are available.
	Only sold per packing unit, cannot be sold seperatly unless we have open boxes in our warehouse. Please call to check availability of single parts.

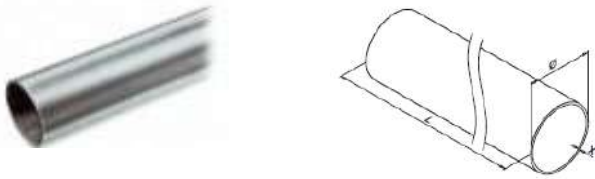

Round Tubular Rail - MOD:0900 Full Lengths

304	Indoor	Ø	X	Ft
13.0900.012.12		1/2" (12mm)	0.078" or 5/64" (2mm)	19'8"
13.0900.019.12		3/4" (19.05mm)	0.078" or 5/64" (2mm)	20'
13.0900.438.12		1-1/2" (38mm)	(4mm) Thick insert for 1-11/16"	19'8"
316	Outdoor			
14.0900.038.12		1-1/2" (38.1mm)	0.078" or 5/64" (2mm)	19'8"
14.0900.042.12		1-11/16" (42mm)	0.078" or 5/64" (2mm)	19'8"
14.0900.050.12		2" (50.8mm)	0.078" or 5/64" (2mm)	19'8"

Saddles are compatible with all of our post tops and most of our wall rail brackets. Available in both Flat and 1-11/16" surface.

316	Outdoor	Saddle	Degree		⊞	Saddles Only
14.S00.000		Flat	180		1	
14.S00.038		1-1/2"	180		1	
14.S00.042		1-11/16"	180		1	
14.S00.300		Flat	135		1	
14.S00.342		1-11/16"	135		1	
14.S00.800		Flat	90		1	
14.S00.838		1-1/2"	90		1	
14.S00.842		1-11/16"	90		1	
316	Outdoor	Saddle	Degree		⊞	Saddles Only
14.S10.000		Flat	180		1	
14.S10.038		1-1/2"	180		1	
14.S10.042		1-11/16"	180		1	

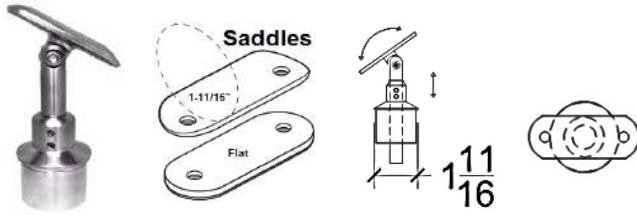

Adjustable Post Top - MOD:510

316	Outdoor	Saddle	Post size	⊞
14.510.000.12		Flat	1-11/16" (42mm)	1
14.510.042.12		1-11/16" (42mm)		1

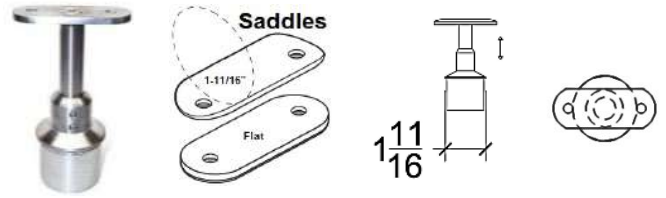

Fixed Post Top - MOD:500

316	Outdoor	Saddle	Post size	⊞
14.500.000.12		Flat	1-11/16" (42mm)	1
14.500.042.12		1-11/16" (42mm)		1

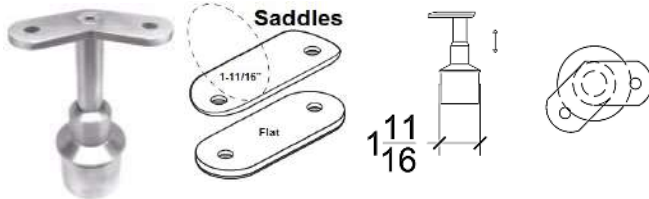

Fixed 135 Post Top - MOD:500.3

316	Outdoor	Saddle	Post size	⊞
14.500.300.12		Flat	1-11/16" (42mm)	1
14.500.342.12		1-11/16" (42mm)		1

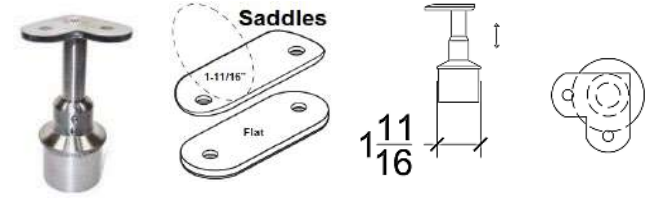

Fixed 90 Post Top - MOD:500.8

316	Outdoor	Saddle	Post size	⊞
14.500.800.12		Flat	1-11/16" (42mm)	1
14.500.842.12		1-11/16" (42mm)		1

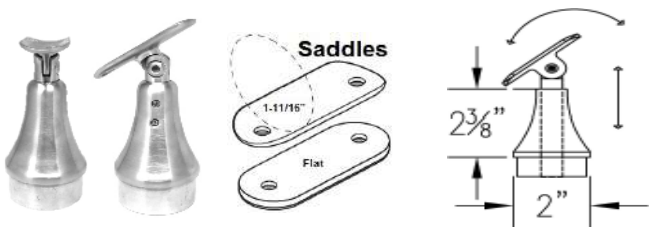

2" Adjustable Post Top - MOD:710

316	Outdoor	Saddle	Post size	⊞
14.710.000.12		Flat	2" (50mm)	1
14.710.042.12		1-11/16" (42mm)		1

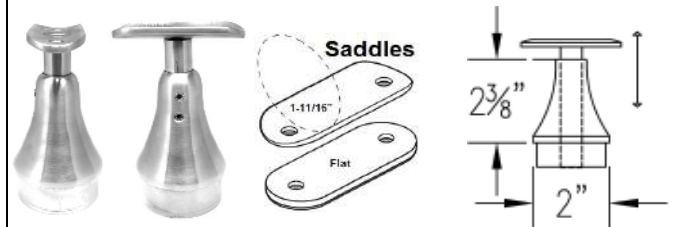

2" Fixed Post Top - MOD:700

316	Outdoor	Saddle	Post size	⊞
14.700.000.12		Flat	2" (50mm)	1
14.700.042.12		1-11/16" (42mm)		1

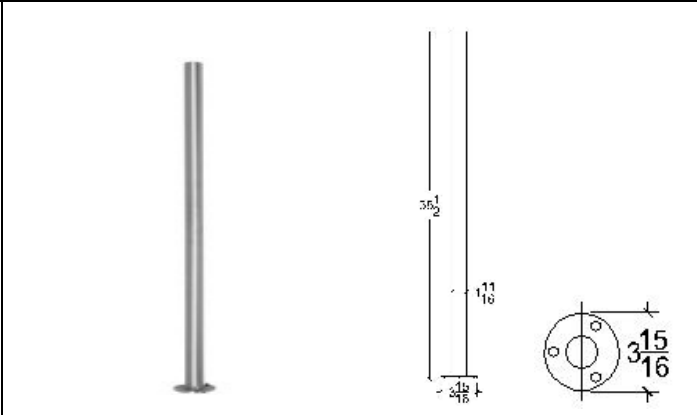

Single Wall 39" Round Top Mount - MOD:5400.0

304	Indoor	Ø	H		
13.5400.038.12	1-1/2" x 0.078"	38.1 x 2.0mm	39"		1
13.5400.042.12	1-11/16" x 0.078"	42 x 2.0mm	39"		1
13.5400.050.12	2" x 0.078"	50.8 x 2.0mm	39"		1
316	Outdoor				
14.5400.038.12	1-1/2" x 0.078"	38.1 x 2.0mm	39"		1
14.5400.042.12	1-11/16" x 0.078"	42 x 2.0mm	39"		1
14.5400.050.12	2" x 0.078"	50.8 x 2.0mm	39"		1

Double wall Round Top Mount - MOD:5400.4

304	Indoor	Ø	H		
13.5400.442.12	1-11/16" x 0.156"	42 x 4.0mm	39"		1
316	Outdoor				
14.5400.442.12	1-11/16" x 0.156"	42 x 4.0mm	39"		1

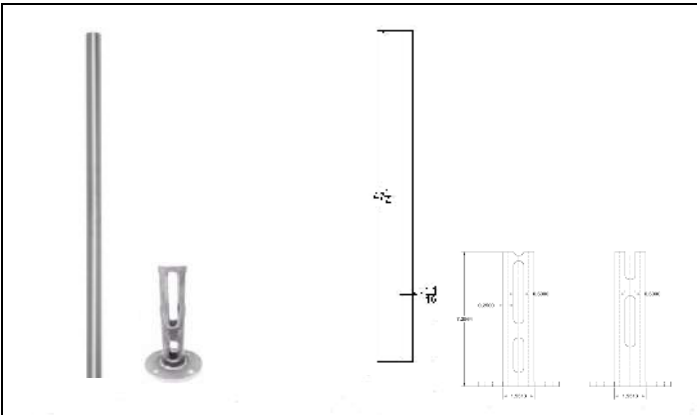

Single Wall Stanchion With Post - MOD:5410.0

304	Indoor	Ø	H		
13.5410.042.12	1-11/16" x 0.078"	42 x 2.0mm	47.25"		1
316	Outdoor	(US Patent 9,447,603)			
14.5410.042.12	1-11/16" x 0.078"	42 x 2.0mm	47.25"		1

Double wall Stanchion With Post - MOD:5410.4

304	Indoor	Ø	H		
13.5410.442.12	1-11/16" x 0.156"	42 x 4.0mm	47.25"		1
316	Outdoor	(US Patent 9,447,603)			
14.5410.442.12	1-11/16" x 0.156"	42 x 4.0mm	47.25"		1

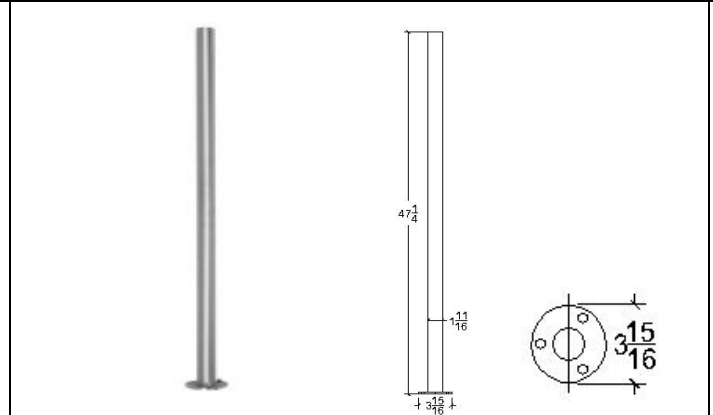

Single Wall 47" Round Top Mount - MOD:5401.0

304	Indoor	Ø	H		
13.5401.038.12	1-1/2" x 0.078"	38.1 x 2.0mm	47"		1
13.5401.042.12	1-11/16" x 0.078"	42 x 2.0mm	47"		1
13.5401.050.12	2" x 0.078"	50.8 x 2.0mm	47"		1
316	Outdoor				
14.5401.038.12	1-1/2" x 0.078"	38.1 x 2.0mm	47"		1
14.5401.042.12	1-11/16" x 0.078"	42 x 2.0mm	47"		1
14.5401.050.12	2" x 0.078"	50.8 x 2.0mm	47"		1

Double wall Round Top Mount - MOD:5401.4

304	Indoor	Ø	H		
13.5401.442.12	1-11/16" x 0.156"	42 x 4.0mm	47"		1
316	Outdoor				
14.5401.442.12	1-11/16" x 0.156"	42 x 4.0mm	47"		1

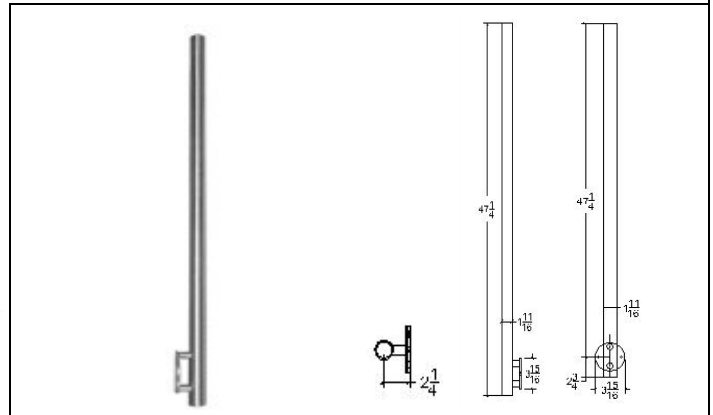

Single Wall Facia Mount - MOD:5420.0

316	Outdoor	Ø	H		
14.5420.042.12	1-11/16" x 0.078"	42 x 2.0mm	47.25"		1

Double wall Facia Mount - MOD:5420.4

316	Outdoor	Ø	H		
14.5420.442.12	1-11/16" x 0.156"	42 x 4.0mm	47.25"		1



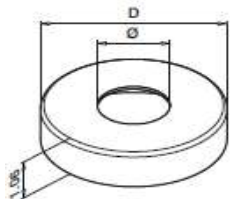

Flange Cover - MOD:0511

304	Indoor	Ø	D			
13.0511.042.12		1-11/16" (42mm)	4-1/3"			1
316	Outdoor					
14.0511.042.12		1-11/16" (42mm)	4-1/3"			1
14.0511.050.12		2" (50.8mm)	4-1/3"			1

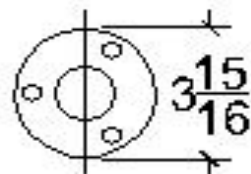

Unwelded Flange - MOD:3501

CS	Indoor	Ø	D	Material		
13.3501.038.12		1-1/2" (38mm)	3-15/16"	Carbon Steel		1
13.3501.042.12		1-11/16" (42mm)	3-15/16"	Carbon Steel		1
13.3501.050.12		2" (50.8mm)	3-15/16"	Carbon Steel		1
304	Outdoor					
14.3501.038.12		1-1/2" (38mm)	3-15/16"	Stainless Steel		1
14.3501.042.12		1-11/16" (42mm)	3-15/16"	Stainless Steel		1
14.3501.050.12		2" (50.8mm)	3-15/16"	Stainless Steel		1

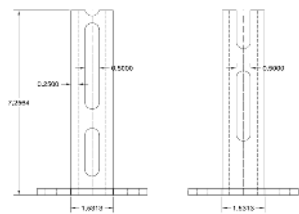

Slotted Round Steel Stanchion - MOD:0946

CS	Indoor	Ø	D			
13.0946.042.12		1-11/16" (42mm)	3-15/16"			1
304	Outdoor			US Patent 9,447,603		
14.0946.042.12		1-11/16" (42mm)	3-15/16"			1

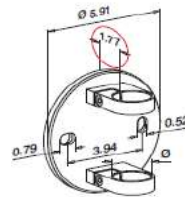

Fascia Bracket - MOD:0551

316	Outdoor	Ø	D			
14.0551.042.12		1-11/16" (42mm)	5.91"			1

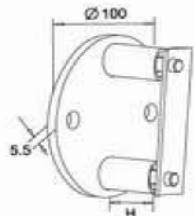

Fascia Bracket - MOD:0552

316	Outdoor	Ø	D			
14.0552.042.12		1-11/16" (42mm)	3-15/16"			1

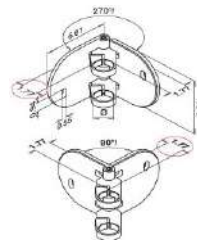

Fascia Corner Bracket - MOD:0555

316	Outdoor	Ø	D			
14.0555.042.12		1-11/16" (42mm)	5.91"			1



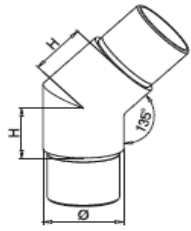

135 Degree Rail Fitting - MOD:0300

316	Outdoor	Ø	H		
14.0300.038.12		1-1/2" (38.1mm)	1-3/16"		1
14.0300.042.12		1-11/16" (42mm)	1-3/16"		1
14.0300.050.12		2" (50.8mm)	1-3/8"		1



Custom Angle

Custom Degree Rail Fitting - MOD:0300C

316	Outdoor	Ø	Angle		
14.0300C.038.12		1-1/2" (38.1mm)	Custom		1
14.0300C.042.12		1-11/16" (42mm)	Custom		1
14.0300C.050.12		2" (50.8mm)	Custom		1

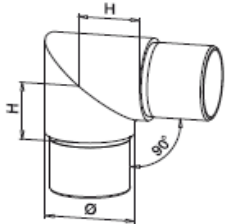

90 Degree, Sharp Rail Fitting - MOD:0301

316	Outdoor	Ø	H		
14.0301.038.12		1-1/2" (38.1mm)	1-3/16"		1
14.0301.042.12		1-11/16" (42mm)	1-3/16"		1
14.0301.050.12		2" (50.8mm)	1-3/8"		1

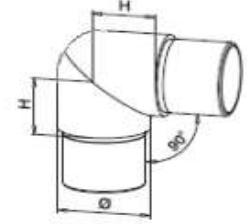

90 Degree, Rounded Rail Fitting - MOD:0303

316	Outdoor	Ø	H		
14.0303.038.12		1-1/2" (38.1mm)	1-3/16"		1
14.0303.042.12		1-11/16" (42mm)	1-3/16"		1
14.0303.050.12		2" (50.8mm)	1-3/8"		1

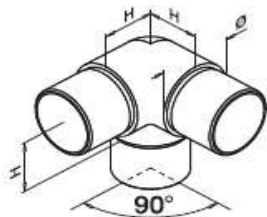

90 Degree, 3-Way Rail Fitting - MOD:0304

316	Outdoor	Ø	H		
14.0304.038.12		1-1/2" (38mm)	1-3/16"		1
14.0304.042.12		1-11/16" (42mm)	1-3/16"		1

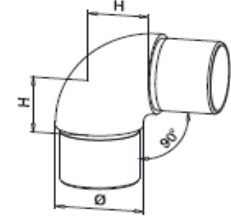

90 Degree, Round Rail Fitting - MOD:0305

316	Outdoor	Ø	H		
14.0305.038.12		1-1/2" (38.1mm)	1-3/16"		1
14.0305.042.12		1-11/16" (42mm)	1-3/16"		1
14.0305.050.12		2" (50.8mm)	1-3/8"		1

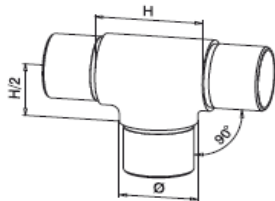

90 Degree, 3-Way Tee Rail Fitting - MOD:0307

316	Outdoor	Ø	H		
14.0307.038.12		1-1/2" (38mm)	2-3/8"		1
14.0307.042.12		1-11/16" (42mm)	2-3/8"		1

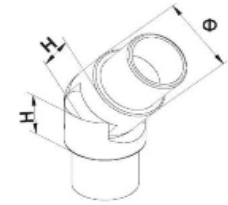

Adjustable angle Rail Fitting - MOD:0312

316	Outdoor	Ø	H		
14.0312.042.12		1-11/16" (42mm)			1

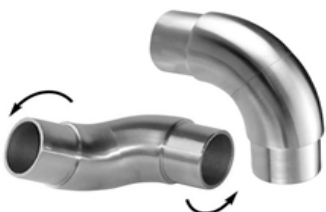

Articulating Fitting - MOD:0313

316	Outdoor	Ø			
14.0313.042.12		1-1/2" (38mm)			1

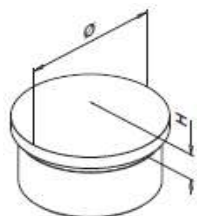

Beveled End Cap - MOD:0729

316	Outdoor	Ø			
14.0729.038.12		1-1/2" (38.1mm)			1
14.0729.042.12		1-11/16" (42mm)			1

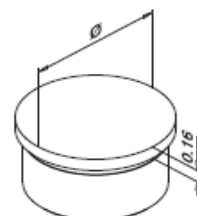

Flat End Cap - MOD:0732

316	Outdoor	Ø			
14.0732.038.12		1-1/2" (38.1mm)			1
14.0732.042.12		1-11/16" (42mm)			1

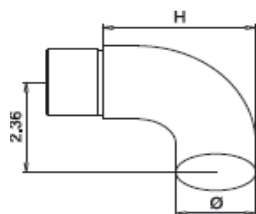

Return End Fitting - MOD:0739

316	Outdoor	Ø	H		
14.0739.038.12		1-1/2" (38.1mm)	3-1/4"		1
14.0739.042.12		1-11/16" (42mm)	3-1/4"		1

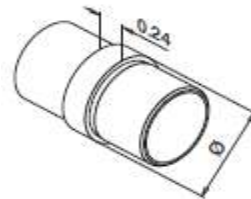

Rail Connector - MOD:0790

316	Outdoor	Ø	H		
14.0790.038.12		1-1/2" (38.1mm)	1/4"		1
14.0790.042.12		1-11/16" (42mm)	1/4"		1
14.0790.050.12		2" (50.8mm)	1/4"		1

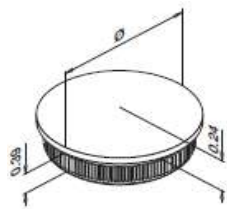

Easy Hit Beveled End Cap - MOD:5729

316	Outdoor	Ø	L		
14.5729.038.12		1-1/2" (38.1mm)	1/4"		1
14.5729.042.12		1-11/16" (42mm)	1/4"		1
14.5729.050.12		2" (50.8mm)	1/4"		1

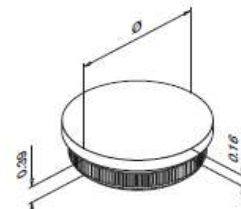

Easy Hit Flat End Cap - MOD:5732

316	Outdoor	Ø	L		
14.5732.038.12		1-1/2" (38.1mm)	5/32"		1
14.5732.042.12		1-11/16" (42mm)	5/32"		1
14.5732.050.12		2" (50.8mm)	5/32"		1

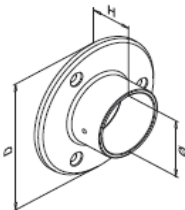

Wall Mount Flange - MOD:0505

316	Outdoor	Ø	D		
14.0505.038.12		1-1/2" (38.1mm)	3-27/32"		1
14.0505.042.12		1-11/16" (42mm)	3-11/32"		1
14.0505.050.12		2" (50.8mm)	4"		1

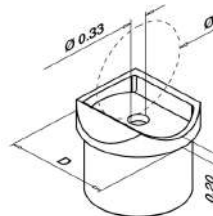

Actual product may be different than images

Adapter - MOD:0722

316	Outdoor	Ø	L		
14.0722.042.12		1-11/16" (42mm)	7/32"		1

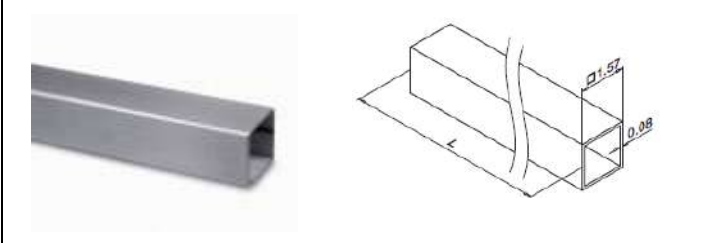

Square Rail - MOD:4900 Full Lengths

304	Indoor	Ø	T		Ft
13.4900.035.12		35mm	0.078" (2mm)	Insert for 1-9/16" Tube	19'8"
316	Outdoor				
14.4900.040.12		1-9/16" (40mm)	0.078" (2mm)		19'8"
14.4900.050.12		2" (50mm)	0.078" (2mm)		19'8"

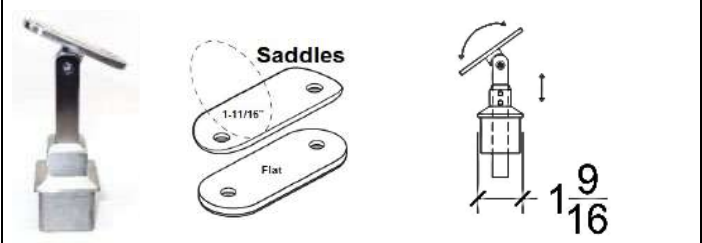

Adjustable Square Post Top - MOD:610

316	Outdoor	Saddle	Post size		
14.610.000.12		Flat	1-9/16" (40mm)		1
14.610.042.12		1-11/16" (42mm)			1

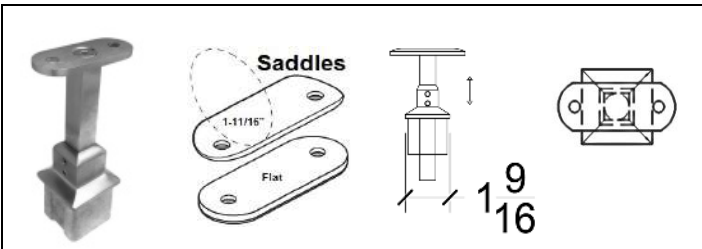

Fixed Square Post Top - MOD:600

316	Outdoor	Saddle	Post size		
14.600.000.12		Flat	1-9/16" (40mm)		1
14.600.042.12		1-11/16" (42mm)			1

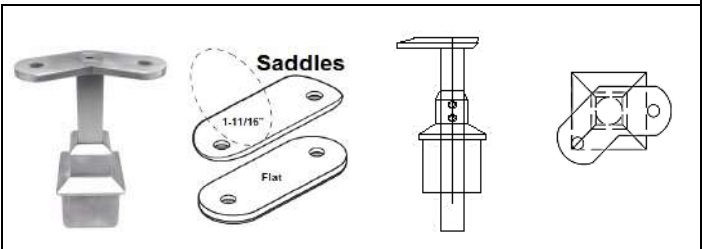

Square 135 Post Top - MOD:600-135

316	Outdoor	Saddle	Post size		
14.600.300.12		Flat	1-9/16" (40mm)		1
14.600.342.12		1-11/16" (42mm)			1

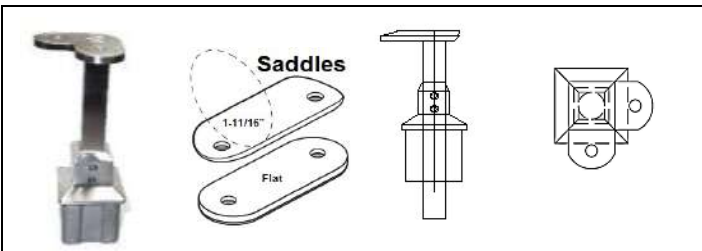

Square 90 Post Top - MOD:600-90

316	Outdoor	Saddle	Post size		
14.600.800.12		Flat	1-9/16" (40mm)		1
14.600.842.12		1-11/16" (42mm)			1

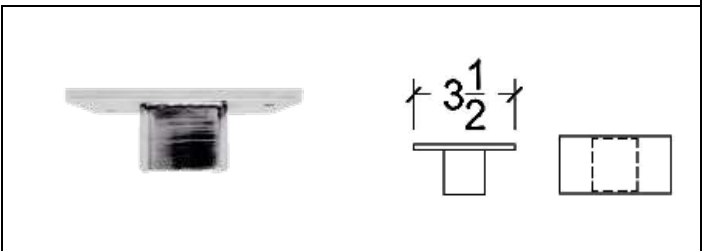

Flat Top - MOD:640F

316	Outdoor	Saddle	Post size		
14.640F.040.12		Flat	1-9/16" (40mm)		1

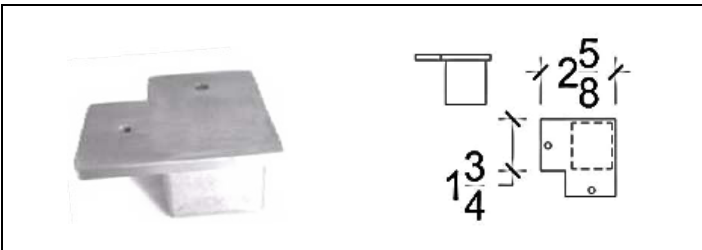

Flat Top, 90 degree - MOD:640F

316	Outdoor	Saddle	Post size		
14.640F.840.12		Flat	1-9/16" (40mm)		1

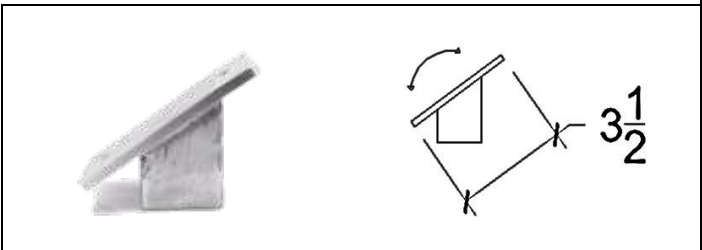

Flat top, Custom Angle - MOD:640C

316	Outdoor	Saddle	Angle	Insert Degree	
14.640C.040.12		1-9/16" (40mm)	Custom		1

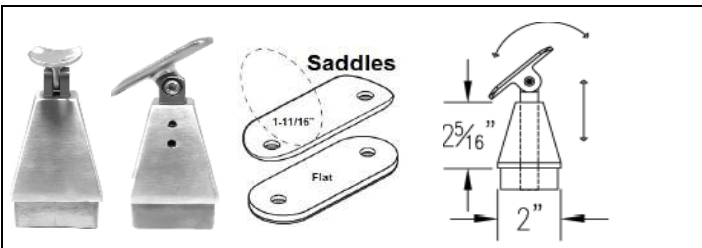

2" Adjustable Square Post Top - MOD:810

316	Outdoor	Saddle	Post size		
14.810.000.12		Flat	2" (50mm)		1
14.810.042.12		1-11/16" (42mm)			1

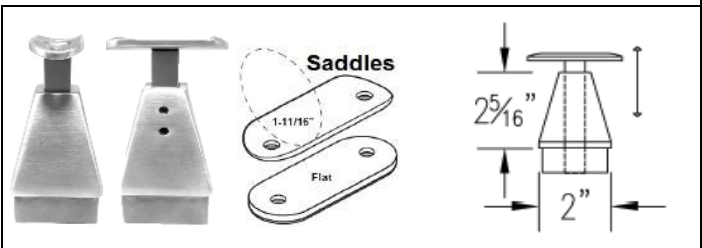

2" Fixed Square Post Top - MOD:800

316	Outdoor	Saddle	Post size		
14.800.000.12		Flat	2" (50mm)		1
14.800.042.12		1-11/16" (42mm)			1

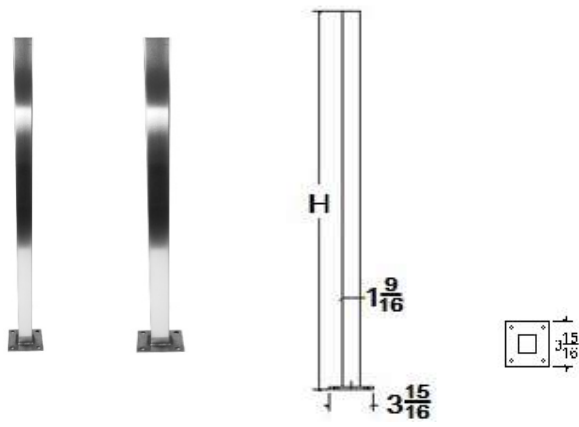

Single Wall		Square Post Top Mount				
304	Indoor	Ø	H		Wall T.	
13.6400.040.12		1-9/16" (40mm)	39"	Standard	2mm	1
13.6400.050.12		2" (50mm)	39"		2mm	1
13.6401.040.12		1-9/16" (40mm)	47"		2mm	1
13.6401.050.12		2" (50mm)	47"		2mm	1
316		Outdoor				
14.6400.040.12		1-9/16" (40mm)	39"	Standard	2mm	1
14.6400.050.12		2" (50mm)	39"		2mm	1
14.6401.040.12		1-9/16" (40mm)	47"		2mm	1
14.6401.050.12		2" (50mm)	47"		2mm	1

Double wall		Square Post Top Mount				
304	Indoor	Ø	H		Wall T.	
13.6400.440.12		1-9/16" (40mm)	39"	Standard	4mm	1
13.6401.440.12		1-9/16" (40mm)	47"		4mm	1
316		Outdoor				
14.6400.440.12		1-9/16" (40mm)	39"	Standard	4mm	1
14.6401.440.12		1-9/16" (40mm)	47"		4mm	1

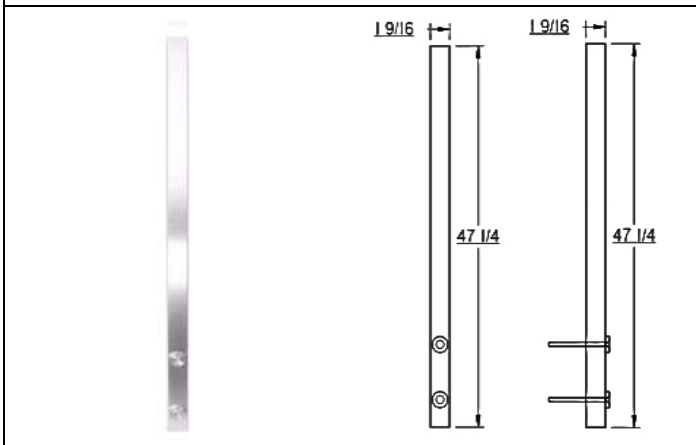

Single Wall		Square Post Facia Mount - Option 2				
316	Outdoor	Ø	H		Wall T.	
14.6430.040.12		1-9/16" (40mm)	47.25"		2mm	1

Double wall		Square Post Facia Mount - Option 2				
316	Outdoor	Ø	H		Wall T.	
14.6430.440.12		1-9/16" (40mm)	47.25"		4mm	1

Square Post Facia Mount - Option 2 (Hardware Only)						
13.6431.040.12	Indoor use (set of two bolts and washers)			304		2
14.6431.040.12	Outdoor use (set of two bolts and washers)			316		2

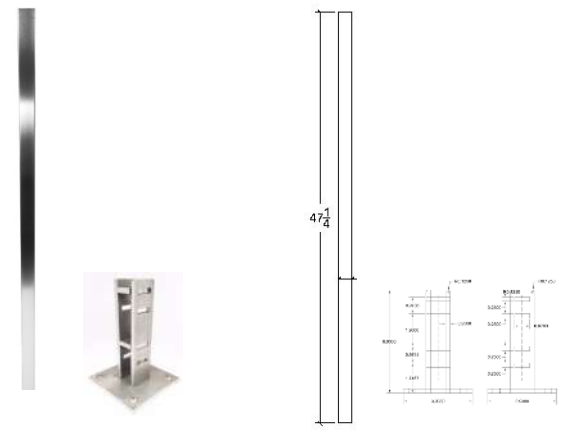

Single Wall		Stanchion With Post - 47.25"				
304	Indoor	Ø	H		Wall T.	
13.6410.040.12		1-9/16" (40mm)	47.25"		2mm	1
316		Outdoor				
US Patent 9,447,603						
14.6410.040.12		1-9/16" (40mm)	47.25"		2mm	1
Double wall		Stanchion With Post - 47.25"				
304	Indoor	Ø	H		Wall T.	
13.6410.440.12		1-9/16" (40mm)	47.25"		4mm	1
316		Outdoor				
US Patent 9,447,603						
14.6410.440.12		1-9/16" (40mm)	47.25"		4mm	1

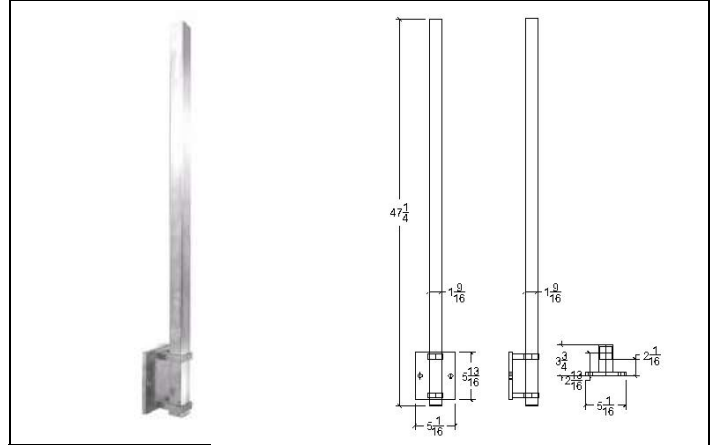

Single Wall		Square Post Facia Mount - Option 1				
316	Outdoor	Ø	H		Wall T.	
14.6420.040.12		1-9/16" (40mm)	47.25"		2mm	1

Double wall		Square Post Facia Mount - Option 1				
316	Outdoor	Ø	H		Wall T.	
14.6420.440.12		1-9/16" (40mm)	47.25"		4mm	1

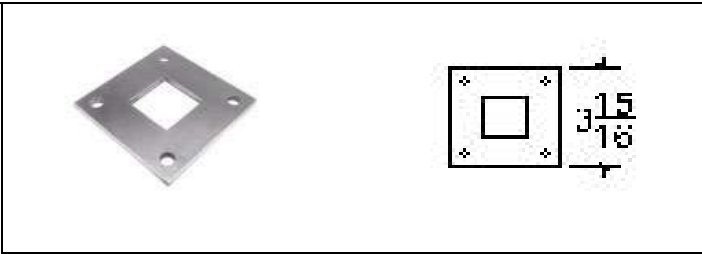

Unwelded Stainless Steel Flange - MOD:4941

CS	Indoor	Ø	D	
13.4941.040.12		1-9/16" (40mm)	3.937"	1
13.4941.050.12		2" (50mm)	3.937"	1
316	Outdoor			
14.4941.040.12		1-9/16" (40mm)	3.937"	1
13.4941.050.12		2" (50mm)	3.937"	1

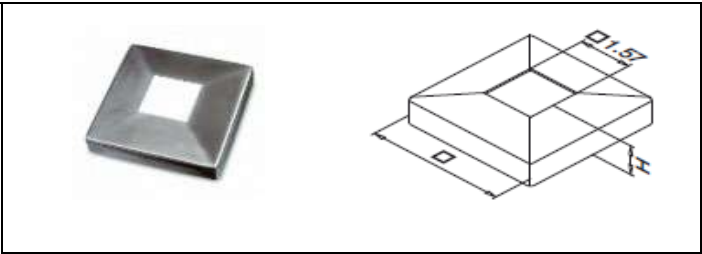

Flange Cover - MOD:4511

304	Indoor	Ø	D	
13.4511.040.12		1-9/16" (40mm)	4-1/4"	1
316	Outdoor			
14.4511.040.12		1-9/16" (40mm)	4-1/4"	1
14.4511.050.12		2" (50mm)	4-1/4"	1

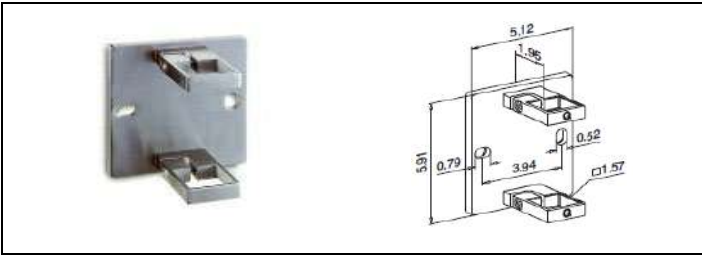

Fascia Mount - MOD:4551

316	Outdoor	Ø		
14.4551.040.12		1-9/16" (40mm)		1

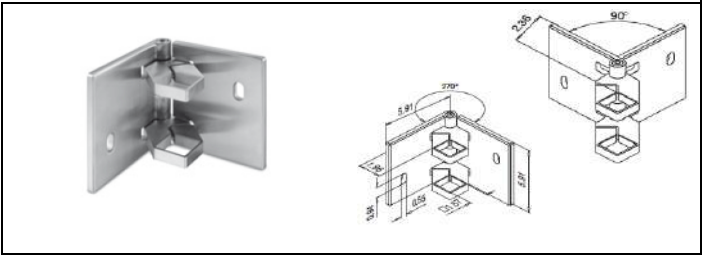

Fascia Mount Corner - MOD:4555

316	Outdoor	Ø	D	
14.4555.040.12		1-9/16" (40mm)	4-1/3"	1

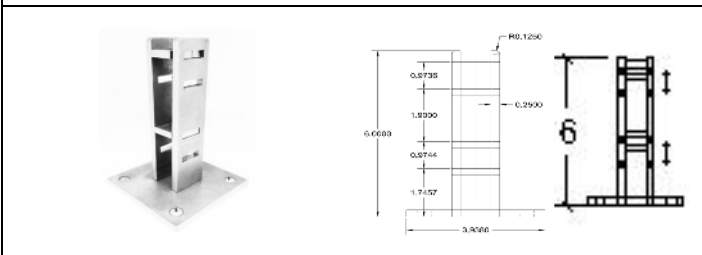

Fixed Square Steel Stanchion - MOD:4948

CS	Indoor	Ø		
13.4948.040.12		1-9/16" (40mm)		1
316	Outdoor		US Patent 9,447,603	
14.4948.040.12		1-9/16" (40mm)		1



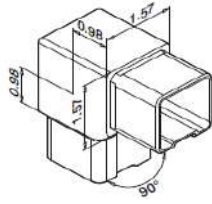

90 Degree - MOD:4301

304	Indoor	Ø	L		
13.4301.040.12		1-9/16" (40mm)	0.98"		1
316	Outdoor				
14.4301.040.12		1-9/16" (40mm)	0.98"		1

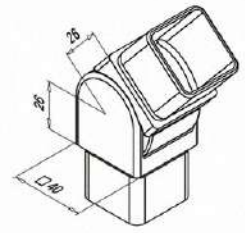

Adjustable angle Rail Fitting - MOD:4302

316	Outdoor	Ø	L		
14.4302.040.12		1-9/16" (40mm)	1.02"		1

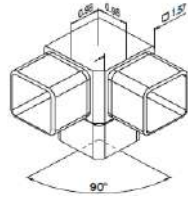

90 Degree, 3-Way Rail Fitting - MOD:4304

316	Outdoor	Ø	L		
14.4304.040.12		1-9/16" (40mm)	0.98"		1

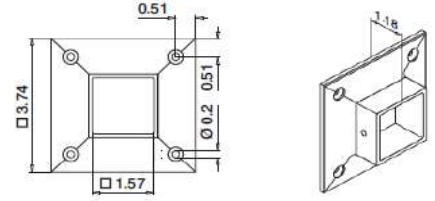

Wall Mount Flange - MOD:4505

304	Indoor	Ø	L		
13.4505.040.12		1-9/16" (40mm)	1.18"		1
316	Outdoor				
14.4505.040.12		1-9/16" (40mm)	1.18"		1

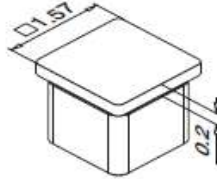

Flat End Cap - MOD:4732

304	Indoor	Ø			
13.4732.040.12		1-9/16" (40mm)			1
316	Outdoor				
14.4732.040.12		1-9/16" (40mm)			1
14.4732.050.12		2" (50mm)			1

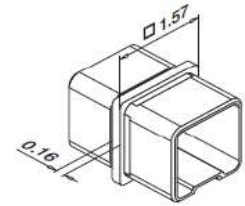

Rail Connector - MOD:4790

304	Indoor	Ø	L		
13.4790.040.12		1-9/16" (40mm)	0.16"		1
316	Outdoor				
14.4790.040.12		1-9/16" (40mm)	0.16"		1

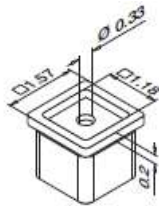

Adapter/End cap - MOD:4732

304	Indoor	Ø	L		
13.4727.000.12		1-9/16" (40mm)	0.2"		1



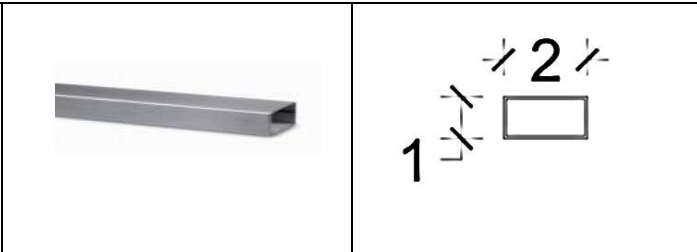

Rectangle Rail - MOD:8300

316	Outdoor	Ø	T	Ft
14.8300.000.12		1x2"	0.065"	19'8"

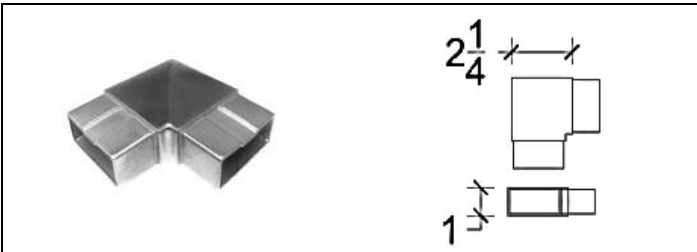

Horizontal 90 degree - MOD:8300

316	Outdoor	Ø	L	
14.8300.450.12		1x2"	2.25"	1

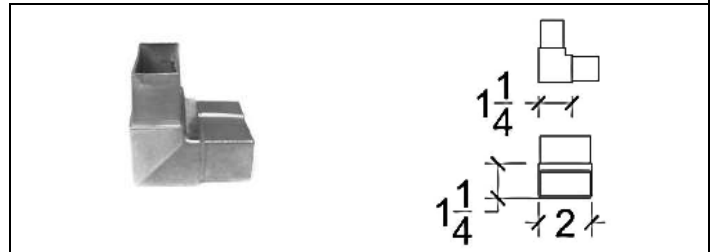

Vertical 90 degree - MOD:8301

316	Outdoor	Ø	L	
14.8301.450.12		1x2"	1.25"	1

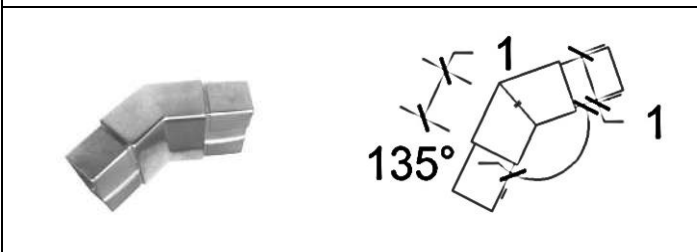

Vertical 135 degree - MOD:8302

316	Outdoor	Ø	L	
14.8302.450.12		1x2"	1.25"	1

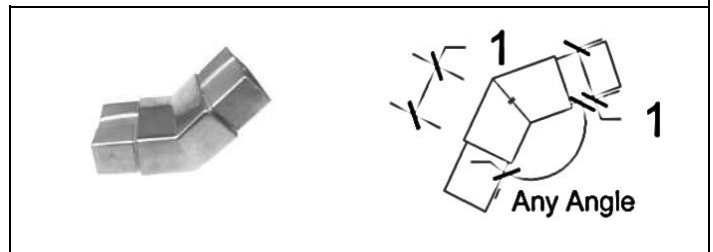

Vertical Custom degree - MOD:8302C

316	Outdoor	Ø	Degree	Insert Degree	
14.8302C.450.12		1x2"	Custom		1

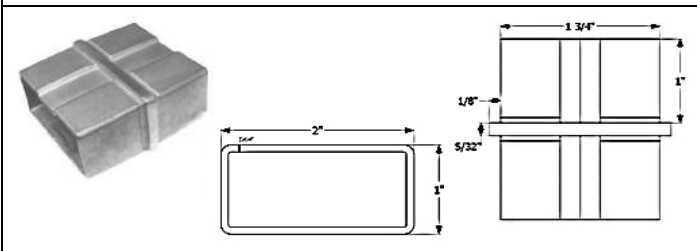

Connector - MOD:8390

316	Outdoor	Ø	L	
14.8390.450.12		1x2"	1/8"	1

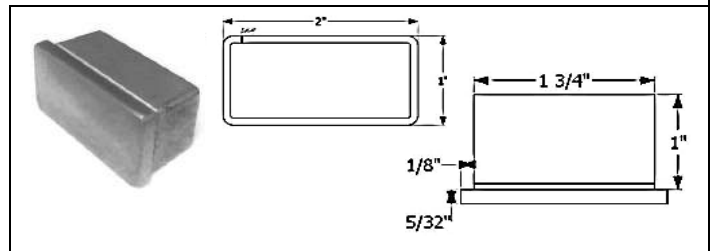

End Cap - MOD:8332

316	Outdoor	Ø	L	
14.8332.450.12		1x2"	1/8"	1

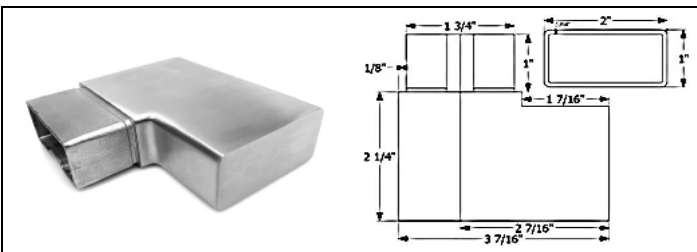

Wall Return - MOD:8390

316	Outdoor	Ø	L	
14.8739.450.12		1x2"	3-7/16"	1



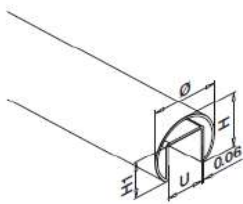

Round Channel Rail - MOD:6920

316	Outdoor	Ø	H	H1	U	T	Ft
14.6900.042.12		1-11/16" (42mm)	1-15/32"	15/16"	15/16"	\$0.06	19'8"

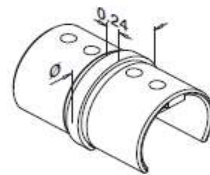

Channel Connector - MOD:6790

316	Outdoor	Ø					
14.6790.042.12		1-11/16" (42mm)					1

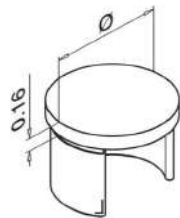

Round Flat End Cap - MOD:6732

316	Outdoor	Ø	L				
14.6732.042.12		1-11/16" (42mm)	0.16"				1

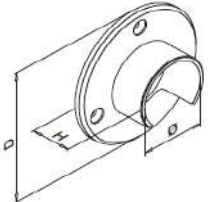

Round Wall Flange - MOD:6505

316	Outdoor	Ø	H	D			
14.6505.042.12		1-11/16" (42mm)	1-3/16"	3-35/64"			1

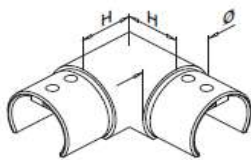

Horizontal 90 degree Fitting - MOD:6313

316	Outdoor	Ø	H				
14.6313.042.12		1-11/16" (42mm)	1-3/16"				1

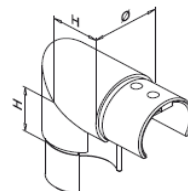

Vertical 90 degree Fitting - MOD:6303

316	Outdoor	Ø	H				
14.6303.042.12		1-11/16" (42mm)	1-3/16"				1

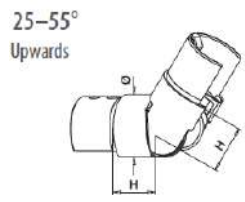

Adjustable Channel Fitting - MOD:6302

316	Outdoor	Ø	Angle	H			
14.6302.042.12		1-11/16" (42mm)	Upwards	1-3/16"			1
14.6312.042.12		1-11/16" (42mm)	Downwards	1-3/16"			1

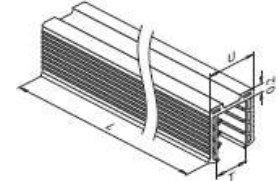

Rubber for Channel Rail - MOD:5042

Rubber	Opening	W	Material		Ft
19.5042.11	5/16"	15/16"	Rubber		1
19.5042.11-20	5/16"	15/16"	Rubber		19'8"



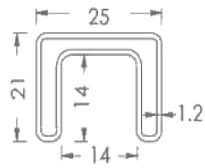

Stainless cap trim rounded corner

316	Outdoor	Height	Width		Ft
14.6920.125.12-1		53/64"	63/64"		1
14.6920.125.12		53/64"	63/64"		19'8"

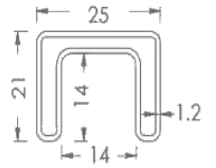
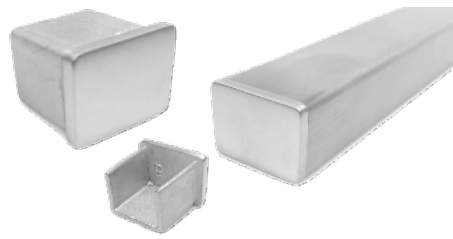

Stainless end cap rounded corner

316	Outdoor	Height	Width		
14.6732.125.12		53/64"	63/64"		1

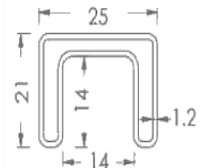

Stainless Connector rounded corner

316	Outdoor	Height	Width		
14.6790.125.12		53/64"	63/64"		1

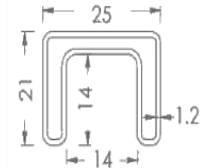
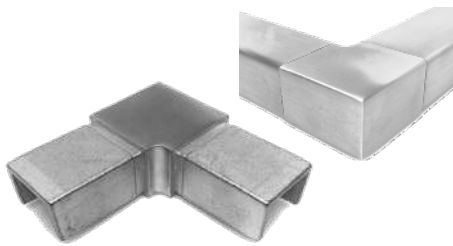

Stainless Horizontal 90° rounded corner

316	Outdoor	Height	Width		
14.6313.125.12		53/64"	63/64"		1

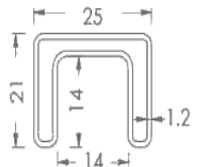

Stainless Wall Flange rounded corner (Key Hole)

316	Outdoor	Height	Width		
14.6506.125.12		53/64"	63/64"		1

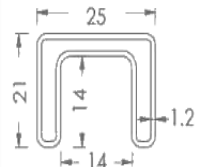
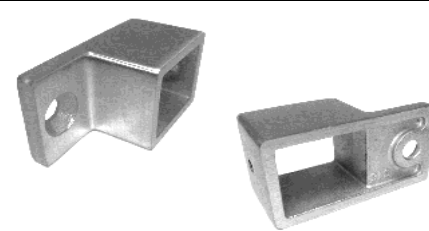

Stainless Wall Flange rounded corner (Horizontal)

316	Outdoor	Height	Width		
14.6507.125.12		53/64"	63/64"		1



Protective Vinyl insert For Cap Trim

Rubber	Opening	For Part #	Ft
19.5042.i10.00	10mm (3/8") Glass	13.6920.125.12	1
19.5042.i12.00	12mm (1/2") Glass	13.6920.125.12	1

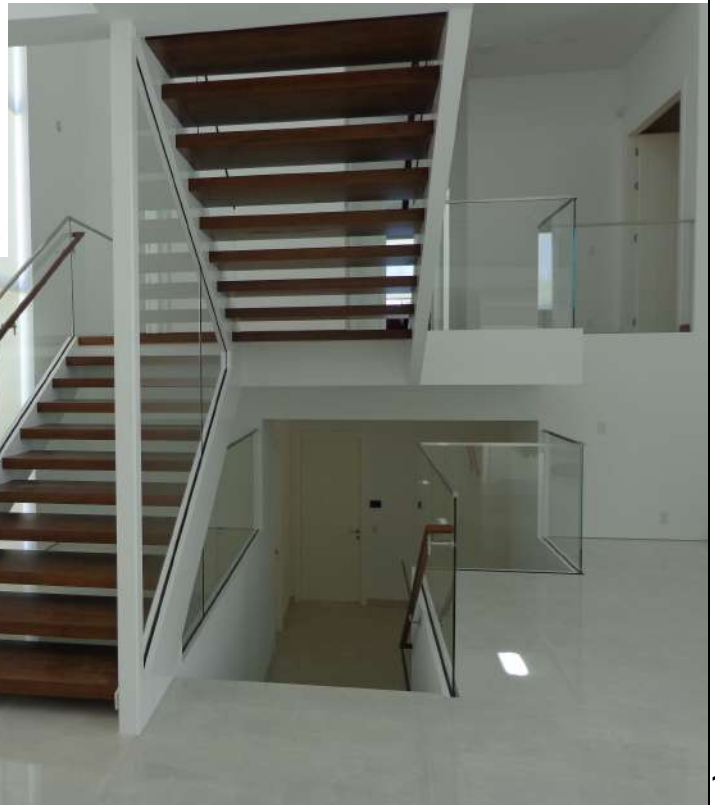



Wood Round Handrail

Poplar	Ø	T	FT
20.8925.038.P	1-1/2" (38mm)	Solid	1
20.8925.042.P	1-11/16" (42mm)	Solid	1
20.8925.050.P	2" (50.8mm)	Solid	1
Oak			
20.8925.038.RO	1-1/2" (38.1mm)	Solid	1
20.8925.042.RO	1-11/16" (42mm)	Solid	1
20.8925.050.RO	2" (50.8mm)	Solid	1
Custom			
20.8925.Custom	?x? Call for custom size and wood species		1

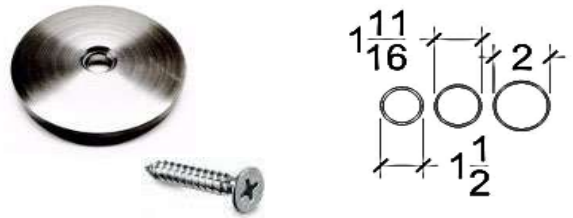

Round End Cap for Wood Rail

304	Indoor	Ø	T	FT
13.20.0001		1-1/2" (38mm)	1/4"	1
13.20.0002		1-11/16" (42mm)	1/4"	1
13.20.0003		2" (50.8mm)	1/4"	1



Wood Square Handrail

Poplar	H	W	FT
20.4925.040.P	1-9/16"	1-9/16"	1
Oak			
20.4925.040.RO	1-9/16"	1-9/16"	1
Custom			
20.4925.Custom	?x? Call for custom size and wood species		1

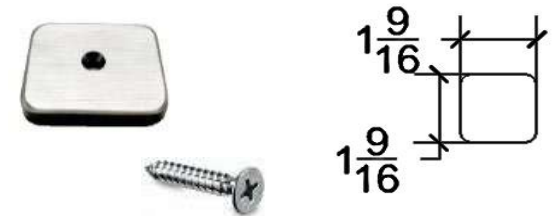

Square End cap for Wood Rail

304	Indoor	Size	T	FT
13.20.0006		1-9/16" (40mm)	1/4"	1

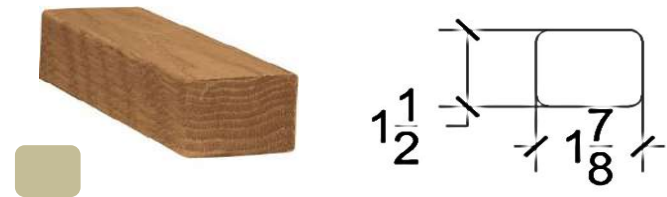

Wood Rectangle Handrail

Poplar	Height	W	FT
20.4925.3847.P	1-1/2"	1-7/8"	1
20.4925.2550.P	1"	2"	1
Oak			
20.4925.3847.RO	1-1/2"	1-7/8"	1
20.4925.2550.RO	1"	2"	1
Custom			
20.4925.Custom	?x? Call for custom size and wood species		1

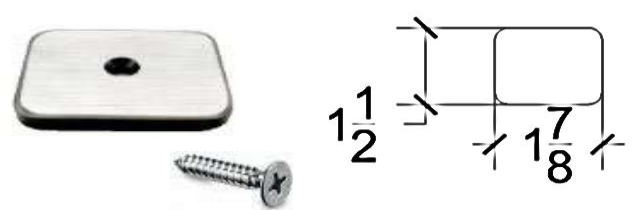

Rectangle End cap for Wood Rail

304	Indoor	Size	T	FT
13.20.0007		1-1/2" x 1-7/8"	1/4"	1

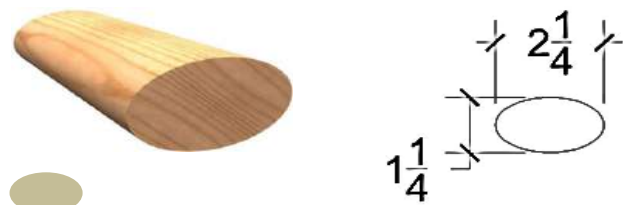

Wood Oval Handrail

Poplar	Ø	T	FT
20.0925.170.P	?	Solid	1
Oak			
20.0925.170.RO	?	Solid	1
Custom			
20.0925.Custom	?x? Call for custom size and wood species		1

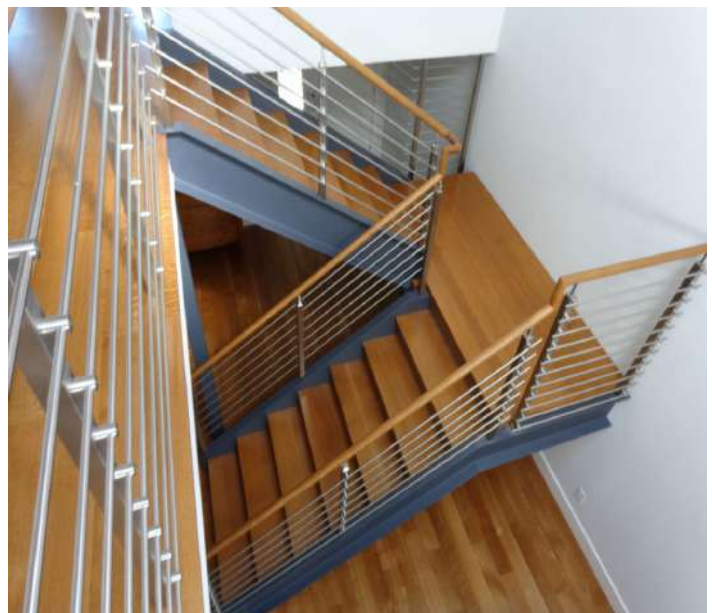

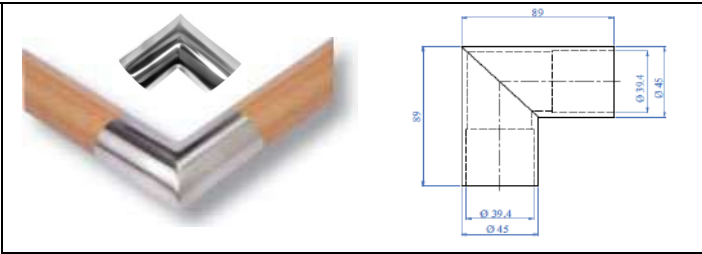

Sharp 90 degree Fitting - MOD:2301

304	Indoor	Ø	Length		
13.2301.042.12		1-11/16" (42mm)	2-15/16"		1

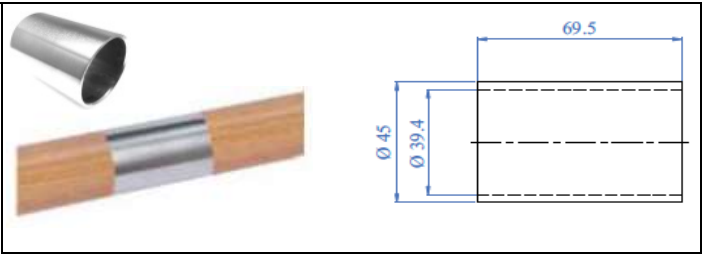

Flush Connector - MOD:2790

304	Indoor	Ø	Length		
13.2790.042.12		1-11/16" (42mm)	2-15/16"		1

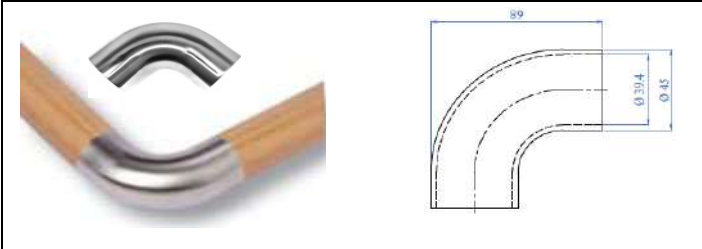

Rounded 90 degree Fitting - MOD:2305

304	Indoor	Ø	Length		
13.2305.042.12		1-11/16" (42mm)	2-15/16"		1

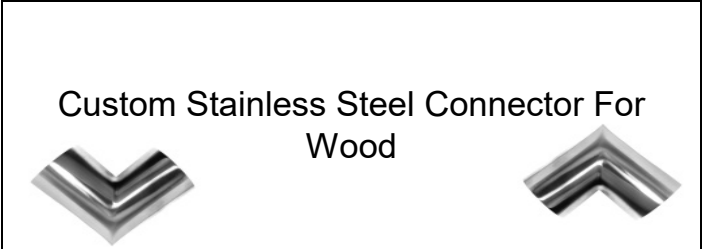

Custom Fitting - MOD:2305C

304	Indoor	Ø	Angle	Insert Degree	
13.2305C.042.12		1-11/16" (42mm)	Custom		1

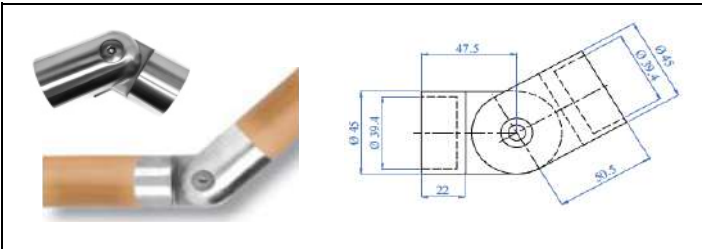

Adjustable fitting - MOD:2302

304	Indoor	Ø	Length		
13.2302.042.12		1-11/16" (42mm)	2-15/16"		1

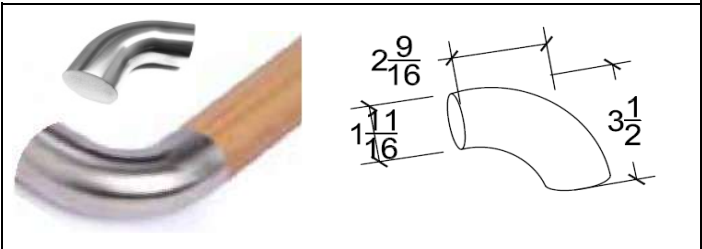

Return End - MOD:2739

304	Indoor	Ø	Length		
13.2739.042.12		1-11/16" (42mm)	2-15/16"		1



End Cap - MOD:2572

304	Indoor	Ø	Length		
13.2572.042.12		1-11/16" (42mm)	1-3/16"		1

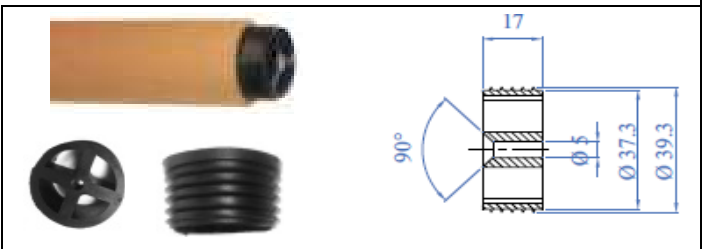

Insert for Stainless fittings. Screws onto Wood Rail - MOD:19.20.000

Plastic	Ø				
19.20.000.00	1-11/16" (42mm)				1

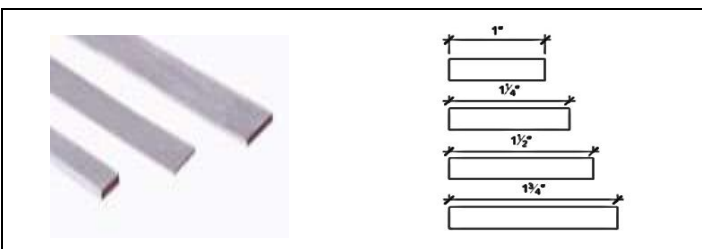

Flat Bar Insert - MOD:4900.644 (For Cable Systems using wood rail)

304	Indoor	Width	Height		Ft
13.4900.644.12		1-3/4"	1/4"		1
316	Outdoor			Up to 20' in Length	
13.4900.644.12		1-3/4"	1/4"		1

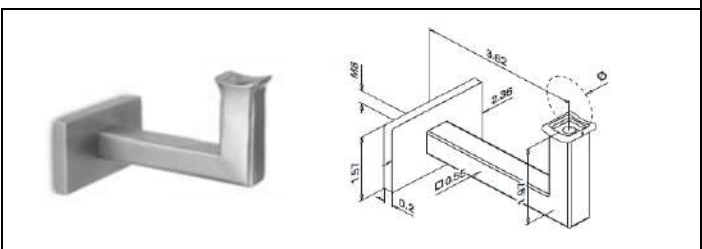

Fixed Wall Mount Bracket - MOD:4111

316	Outdoor	Saddle	Length	Type	
14.4111.000.12		Flat	3.62	Fixed	1

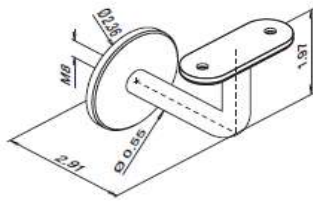

Concealed Hardware Wall Rail Bracket - MOD:0111

316	Outdoor	Saddle	Length	Type		
14.0111.000.12		Flat	2.91"	Fixed		1
14.0111.038.12		1-1/2" (38mm)	2.91"	Fixed		1
14.0111.042.12		1-11/16" (42mm)	2.91"	Fixed		1

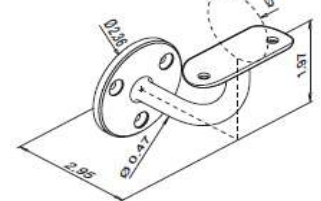

Exposed Hardware Wall Rail Bracket - MOD:0112

304	Indoor	Saddle	Length	Type		
13.0112.038.12		1-1/2" (38mm)	2.95"	Fixed		1
13.0112.042.12		1-11/16" (42mm)	2.95"	Fixed		1

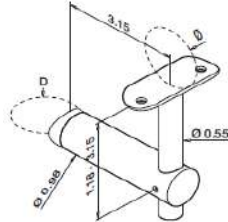

Fixed Round Post Mount Bracket - MOD:0130 or 0138

316	Outdoor	Saddle	Diameter	L	Type	
14.0138.038.12		1-1/2" (38mm)	1-1/2" (38mm)	3.15	Fixed	1
14.0138.042.12		1-11/16" (42mm)	1-11/16" (42mm)	3.15	Fixed	1

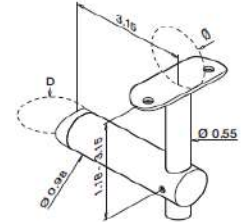

Adjustable Round Post Mount Bracket - MOD:0139

304	Indoor	Saddle	Diameter	L	Type	
13.0139.042.12		1-11/16" (42mm)	1-11/16" (42mm)	3.15	Adj.	1
316	Outdoor					
14.0139.038.12		1-1/2" (38mm)	1-11/16" (42mm)	3.15	Adj.	1

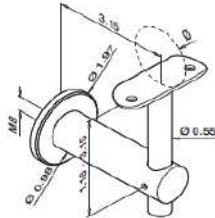

Fixed Wall Rail Bracket - MOD:0140

304	Indoor	Saddle	Length	Type		
13.0140.042.12		1-11/16" (42mm)	3.15"	Fixed/Adjustable		1

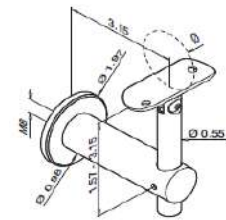

Adjustable Wall Rail Bracket - MOD:0145

304	Indoor	Saddle	Length	Type		
13.0145.042.12		1-11/16" (42mm)	3.15"	Adjustable		1
316	Outdoor					
14.0145.038.12		1-1/2" (38mm)	3.15"	Adjustable		1
14.0145.042.12		1-11/16" (42mm)	3.15"	Adjustable		1

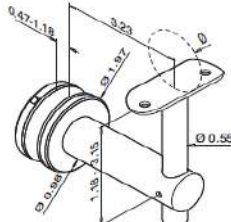

Fixed Glass Mount Bracket - MOD:0150

304	Indoor	Saddle	Length	Type		
13.0150.000.12		Flat	3.23	Fixed		1
13.0150.042.12		1-11/16" (42mm)	3.23	Fixed		1

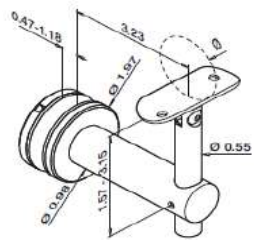

Adjustable Glass Mount Bracket - MOD:0155

304	Indoor	Saddle	Length	Type		
13.0155.000.12		Flat	3.23	Adjustable		1
13.0155.042.12		1-11/16" (42mm)	3.23	Adjustable		1

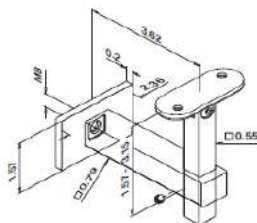

Adjustable Wall Mount Bracket - MOD: 4145

304	Indoor	Saddle	Length	Type		
13.4145.038.12		1-1/2" (38mm)	3.62	Adjustable		1
316	Outdoor					
14.4145.000.12		Flat	3.62	Adjustable		1

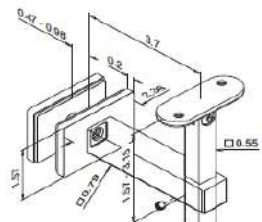

Adjustable Glass Mount Bracket - MOD: 4155

304	Indoor	Saddle	Length	Type		
13.4155.000.12		Flat	3.7	Adjustable		1
13.4155.038.12		1-1/2" (38mm)	3.7	Adjustable		1

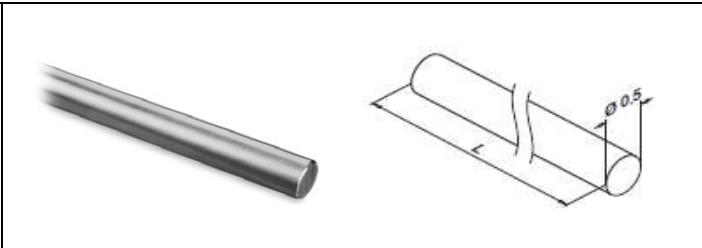

Solid Round Rod - MOD:0912.012

304	Indoor	Ø		Ft
13.0912.012.12-1		1/2" (12mm)	Sold per foot, Cut charge will apply	1'
13.0912.012.12		1/2" (12mm)	Full Length	19'8"

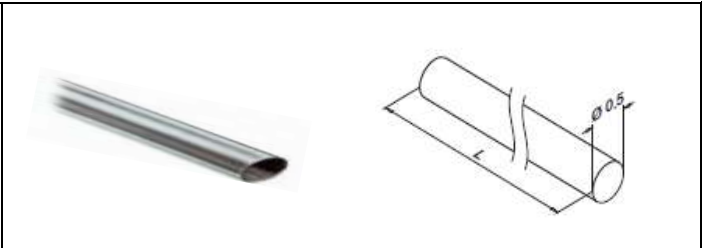

1/2" Round Tube - MOD:0900.012

304	Indoor	Ø	T		Ft
13.0900.012.12-1		1/2" (12mm)	0.065	Sold per foot, Cut charge will apply	1
13.0900.012.12		1/2" (12mm)	0.065	Full Length	19'8"

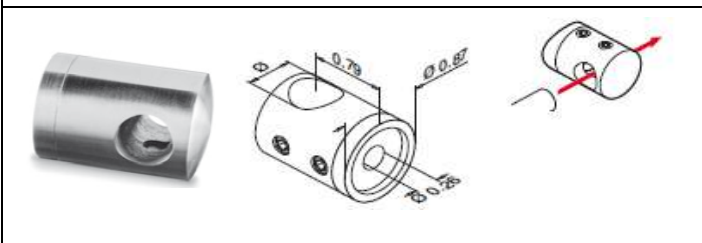

Standard Rod Holder - MOD:0830

304	Indoor	Surface	Ø		⊠
13.0830.000.12		Flat	1/2"		1
13.0830.042.12		1-11/16" (42mm)	1/2"		1

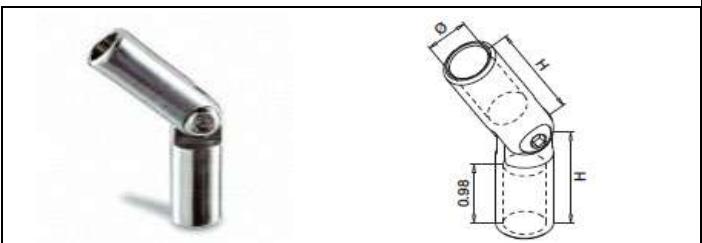

Adjustable Rod Holder - MOD:0302

304	Indoor	Ø	H		⊠
13.0302.012.12		1/2" (12mm)	1-27/64"		1

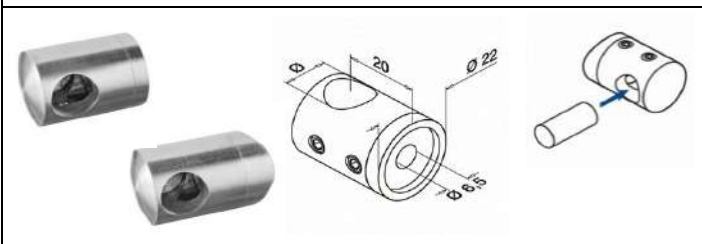

Left Hand Capped Rod Holder - MOD:0832

304	Indoor	Surface	Ø		⊠
13.0832.042.12		1-11/16" (42mm)	1/2"		1

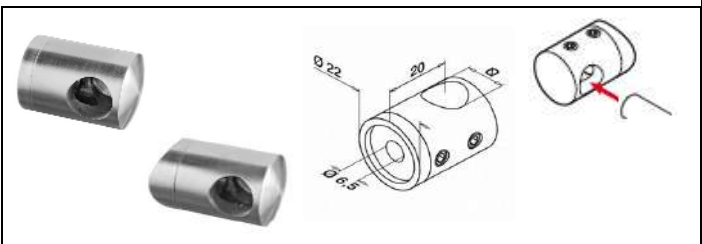

Right Hand Capped Rod Holder - MOD:0833

304	Indoor	Surface	Ø		⊠
13.0833.042.12		1-11/16" (42mm)	1/2"		1

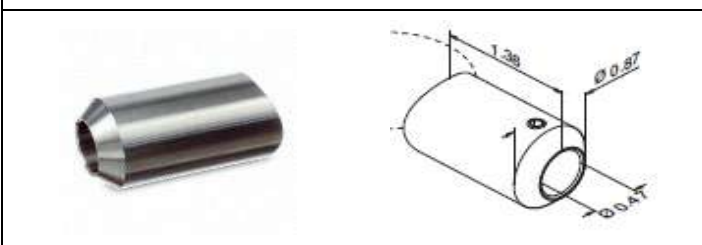

In Line Rod Holder - MOD:0850

304	Indoor	Surface	Ø		⊠
13.0850.042.12		1-11/16" (42mm)	1/2"		1

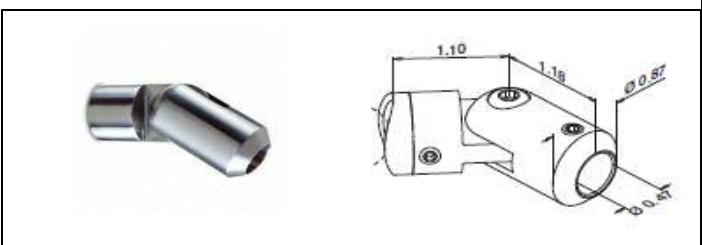

Adjustable In line Rod Holder - MOD:0855

304	Indoor	Surface	Ø		⊠
13.0855.042.12		1-11/16" (42mm)	1/2"		1

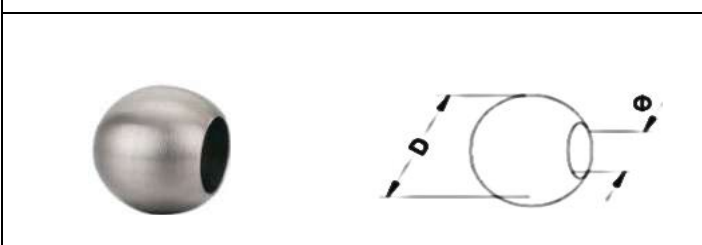

Sphere End Cap - MOD:1735

304	Indoor	Diameter	Ø		⊠
13.1735.012.12		3/4"	1/2"		1

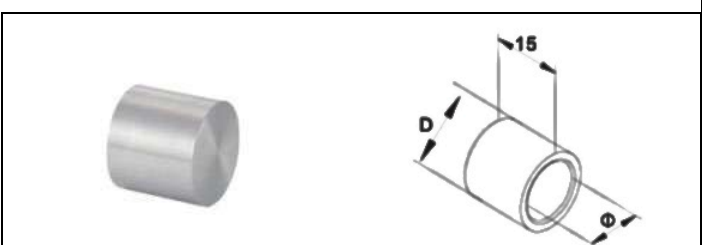

End Cap for 1/2" Tube or Rod - MOD:1737

316	Outdoor	Diameter	Length		⊠
14.1737.012.12		5/8"	9/16"		1

Rod and Flat Bar Components

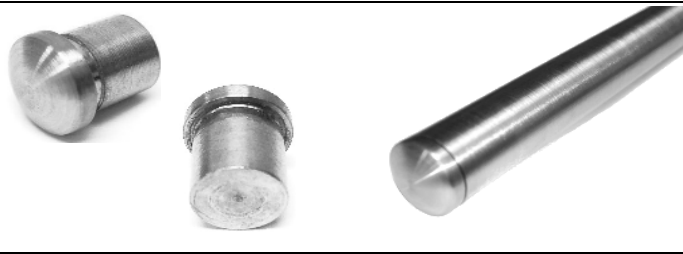

New End Cap for 1/2" Tube - MOD:1729

316	Outdoor	Diameter	Length		
14.1729.012.12		1/2"	9/16"		1

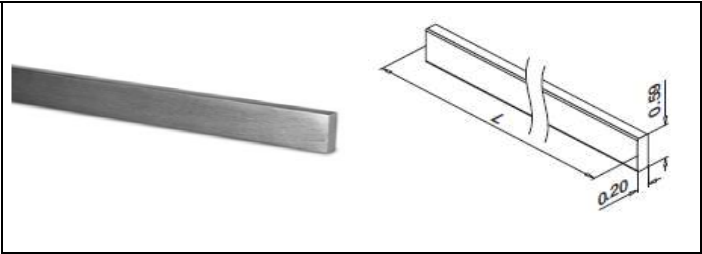

Flat Bar - MOD:4900.015

316	Outdoor	Ø	Option		Ft
14.4900.015.12-1		0.59" - 0.20" (15x5mm)	Sold per foot		1
14.4900.015.12		0.59" - 0.20" (15x5mm)	Full Length		9'

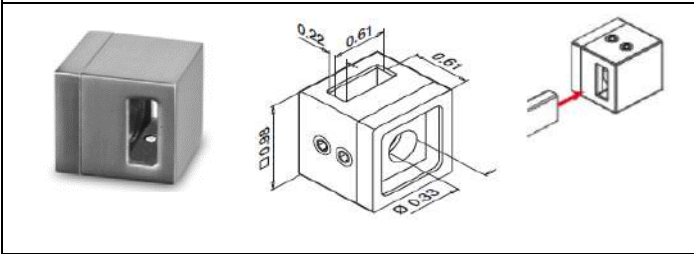

Center Cross Bar Holder - MOD:4820

316	Outdoor	Ø			
14.4820.000.20		0.59" - 0.20" (15x5mm)			1

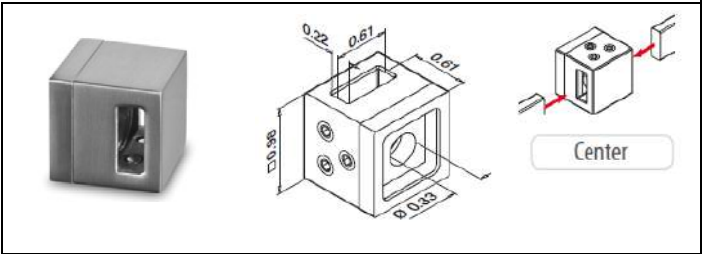

Center Connecting Cross Bar Holder - MOD:4821

316	Outdoor	Ø			
14.4821.000.20		0.59" - 0.20" (15x5mm)			1

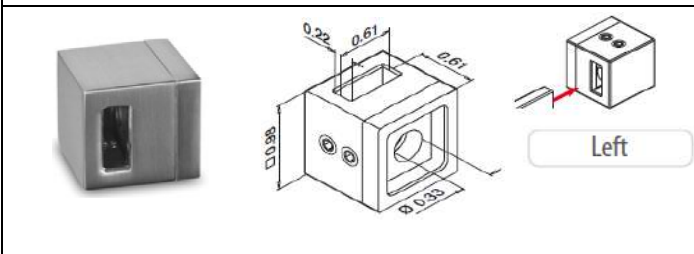

Left Cross Bar Holder - MOD:4822

316	Outdoor	Ø			
14.4822.000.20		0.59" - 0.20" (15x5mm)			1

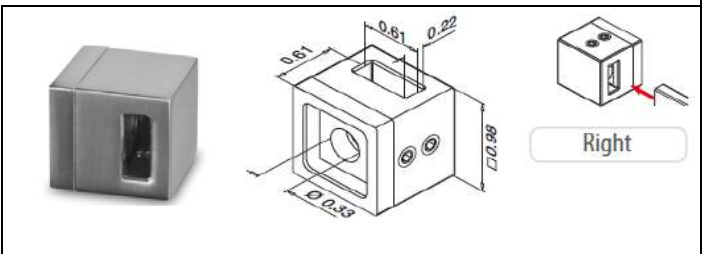

Right Cross Bar Holder - MOD:4823

316	Outdoor	Ø			
14.4823.000.20		0.59" - 0.20" (15x5mm)			1



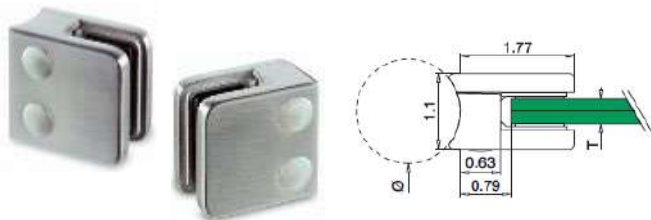

Small Square Glass Clip - MOD:21

304	Indoor	Surface	T	Type		
13.2110.000.12		Flat	3/8" (10mm)	Square		1
13.2110.042.12		1-11/16" (42mm)	3/8" (10mm)	Square		1
316	Outdoor					
14.2110.000.12		Flat	3/8" (10mm)	Square		1
14.2110.042.12		1-11/16" (42mm)	3/8" (10mm)	Square		1

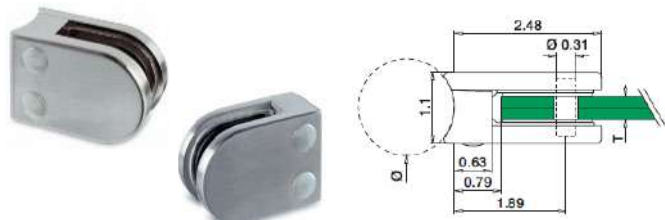

Round Glass Clip - MOD:22

304	Indoor	Surface	T	Type		
13.2210.000.12		Flat	3/8" (10mm)	Round		1
13.2210.042.12		1-11/16" (42mm)	3/8" (10mm)	Round		1
316	Outdoor					
14.2210.000.12		Flat	3/8" (10mm)	Round		1
14.2210.042.12		1-11/16" (42mm)	3/8" (10mm)	Round		1

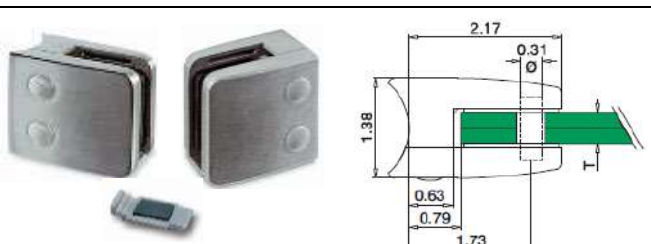

Large Square Glass Clip - MOD:26

316	Outdoor	Surface	T	Type		
14.2612.000.12		Flat	1/2" (12mm)	Square		1
14.2612.042.12		1-11/16" (42mm)	1/2" (12mm)	Square		1

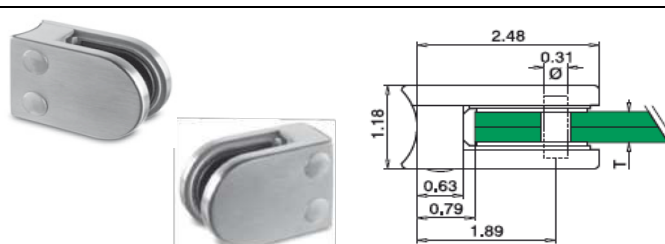

Thick Round Glass Clip - MOD:25

304	Indoor	Surface	T	Type		
13.2512.000.12		Flat	1/2" (12mm)	Round		1
13.2512.042.12		1-11/16" (42mm)	1/2" (12mm)	Round		1
316	Outdoor					
14.2512.000.12		Flat	1/2" (12mm)	Round		1

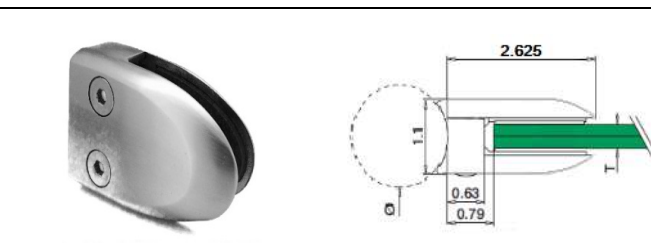

Novo Glass Clip - MOD:23

304	Indoor	Surface	T	Type		
13.2310.000.12		Flat	3/8" (10mm)	Novo		1
13.2310.042.12		1-11/16" (42mm)	3/8" (10mm)	Novo		1

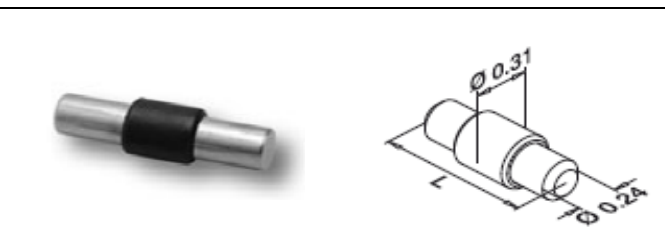

Glass Pin - MOD:5015

316	Outdoor	For Model Glass Clip	L		
19.5015.022.00		MOD:22	7/8" (22mm)		4
19.5015.025.00		MOD:25,26	63/64" (25mm)		4
19.5015.030.00		MOD:6000	1-3/16"		4

Extra

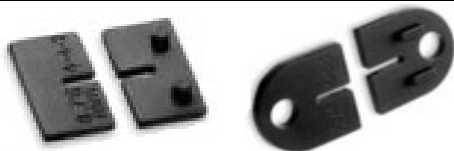

Rubber	Glass Clip Model	T		
19.5002.006.00	MOD:21	1/4" (6mm)		8
19.5002.095.00	MOD:21	3/8" (9.52mm)		8
19.5002.010.00	MOD:21	3/8" (10mm)		8
19.5004.095.00	MOD:22	3/8" (9.52mm)		8
19.5009.010.00	MOD:25	3/8" (10mm)		8
19.5009.011.00	MOD:25	3/8" Lam. (10.76mm)		8
19.5009.012.00	MOD:25	1/2" (12mm)		8
19.5011.010.00	MOD:26	3/8" (10mm)		8
19.5011.012.00	MOD:26	1/2" (12mm)		8

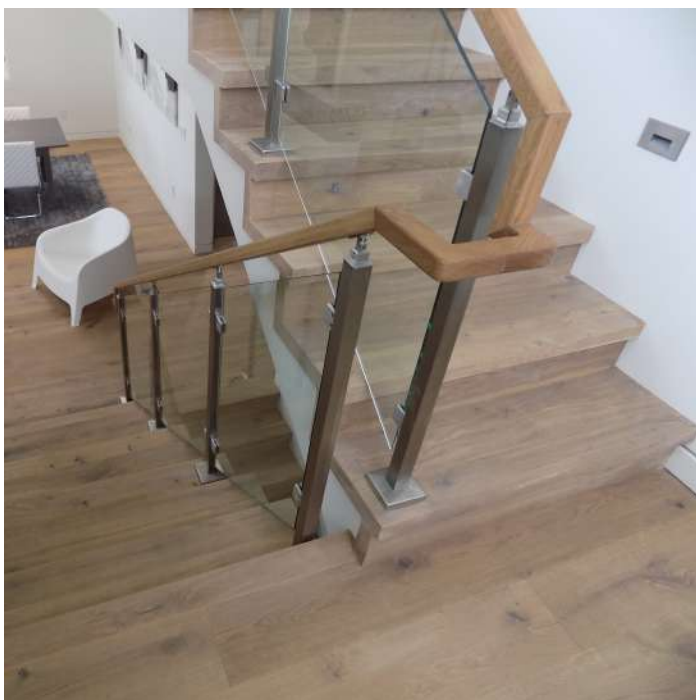

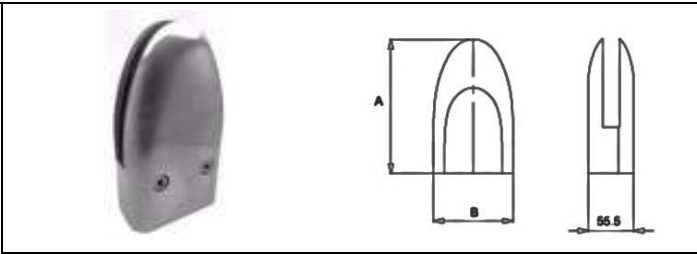

Glass Stanchion - MOD:6100

316	Outdoor	Surface	T			
14.6112.000.12		Flat	1/2" (12mm)			1

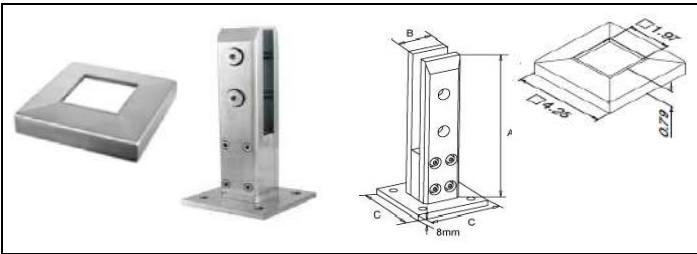

Glass Stanchion - MOD:6300

316	Outdoor	Surface	T			
14.6312.000.12		Flat	1/2" (12mm)			1
14.4511.050.12		Flange cover				1

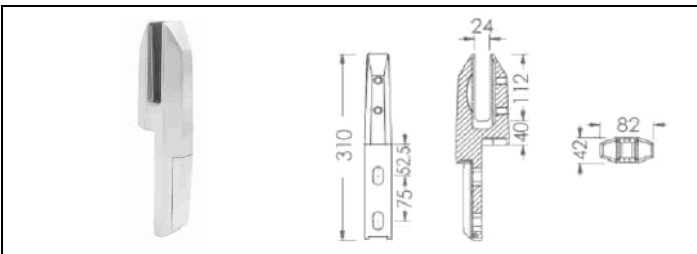

Glass Stanchion: Edge Mount - MOD:EDGE82

2205	Outdoor	Surface	T			
14.EDGE82.12		Flat/Edge	1/2" (12mm)			1

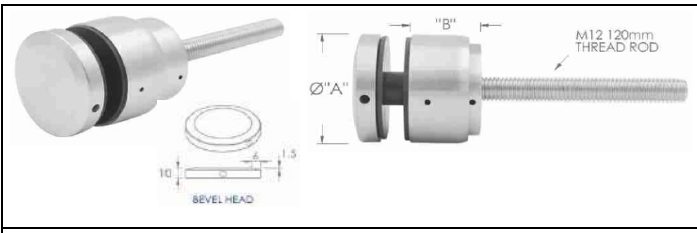

Ajustable Length Round Barrel Clip - MOD:0748

2205	Outdoor	Surface	T	H	Glass Hole	
14.0748.000.12		Flat	1/2"-7/8"	1-3/16"	Min. 20mm	1

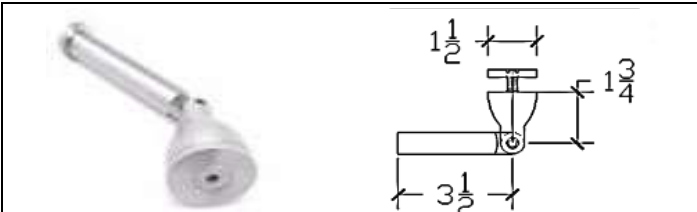

Spider Arm - MOD:27

304	Indoor	Surface	T			
13.2700.000.12		Flat	3/8" (10mm) to 1/2" (12mm)			1

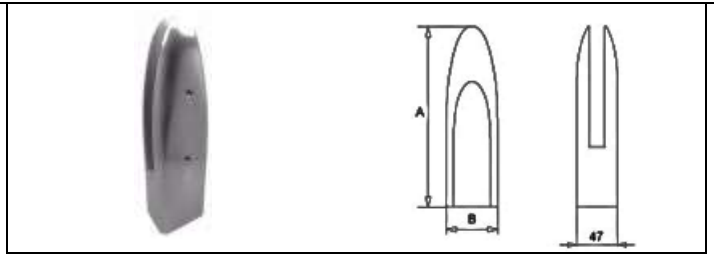

Glass Stanchion - MOD:6200

316	Outdoor	Surface	T			
14.6212.000.12		Flat	1/2" (12mm)			1

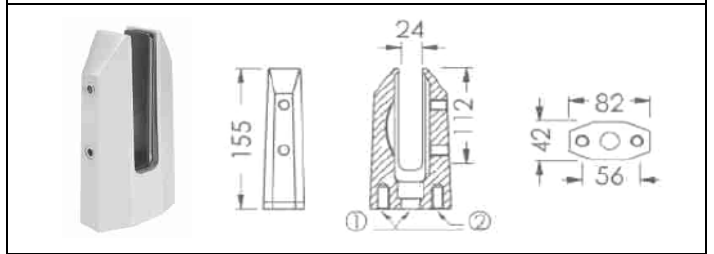

Glass Stanchion - MOD:SE82X

2205	Outdoor	Surface	T			
14.SE82X.12		Flat	1/2" (12mm)			1

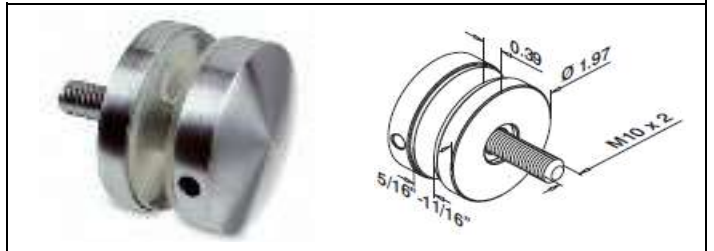

Round Barrel Clip - MOD:0747

304	Indoor	Option	T			
13.0747.000.12		Cambered	1/2" (12mm)			1
13.0747.000.12-F		Flat	1/2" (12mm)			1

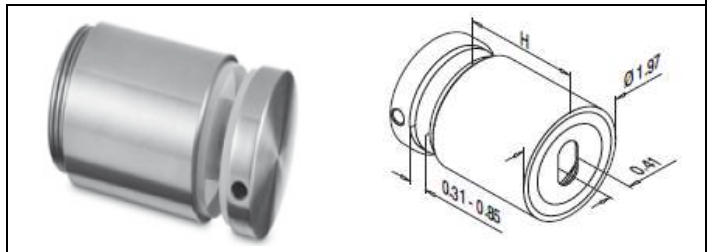

Round Barrel Clip - MOD:0749

316	Outdoor	Surface	T	H		
14.0749.400.12		Flat	5/16"-1"	1-9/16"		1



TILT-LOCK BASE RAIL PATENTED ADJUSTABLE SYSTEM

With Aluminium and
Stainless Steel Cover



TILT-LOCK ADJUSTMENT - PERFECT ALIGNMENT

- Patented rotating pressure plate system
- Up to 30mm tilt adjustment back and forward
- Tilt adjustment from inside of the balcony

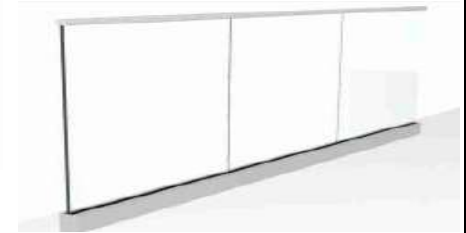
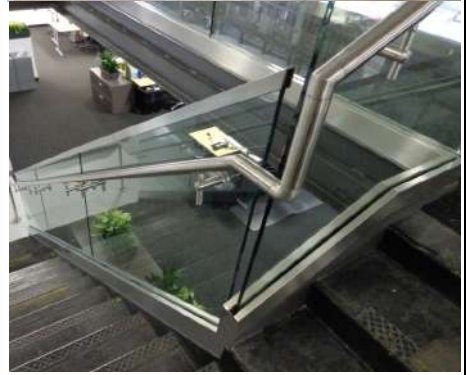
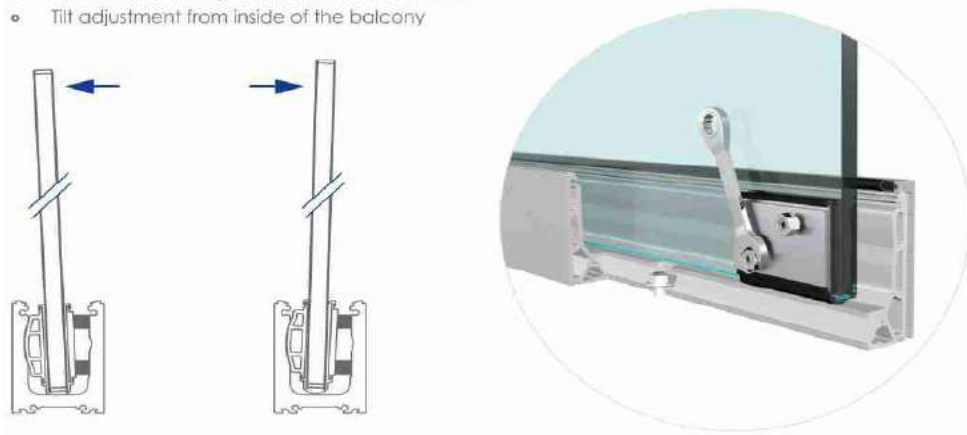

TOP, SIDE FIXED AND RECESSED APPLICATIONS

- Top fixed application
- Side fixed application
- Recessed application

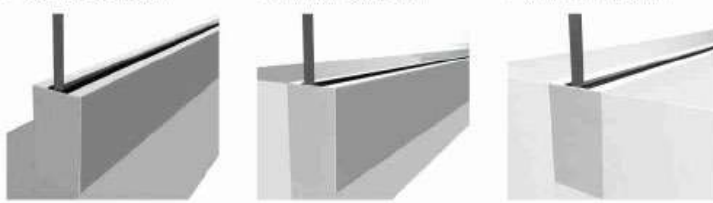

TOP FIXED MODEL	SIDE FIXED MODEL	RECESSED MODEL
2x long covers with rubbers	1x long cover & 1x short cover with rubber, 1x bottom cover	2x short covers with rubbers

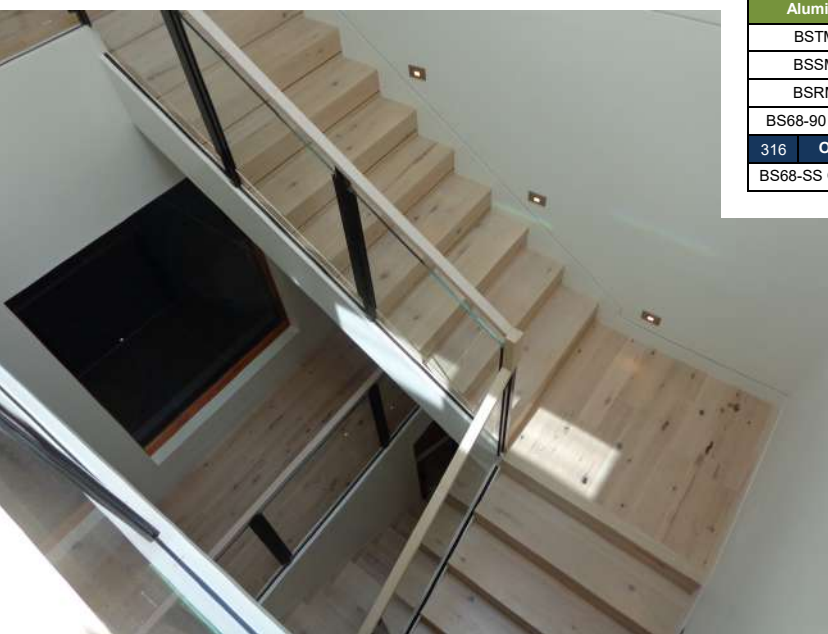

Base Shoe/Channel			
Aluminum	Option	Size Height x Width	
BSTM68	Top Mount	98x72mm (3-55/64"x2-53/64")	1
BSSM68	Side Mount	98x72mm (3-55/64"x2-53/64")	1
BSRM68	Recessed	98x72mm (3-55/64"x2-53/64")	1
BS68-90 Degree	90° Corner	98x72mm (3-55/64"x2-53/64")	1
316	Outdoor		
BS68-SS Cladding	Stainless Steel	98x72mm (3-55/64"x2-53/64")	1



Stainless Steel Cable

316	Outdoor	Ø	Description		ft
C.125		1/8"	Cut to size per order Add 1.00 Cut and 3.00 swage charge per cable		1
C.1875		3/16"			1

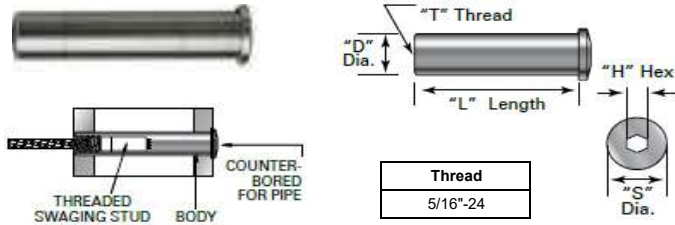

Receiver

316	Outdoor	Ø	Width	length		⊠
R-6-22		1/8" / 3/16"	.537"	1.182"		1
R-6-32		1/8" / 3/16"	.537"	2.030"		1

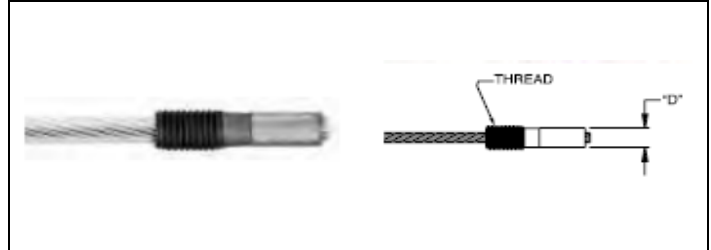

Swaging Stud

316	Outdoor	Ø	Thread	D after Swaged		⊠
S-4		1/8"	5/16"-24	1/4"		1
S-6		3/16"	5/16"-24	1/4"		1

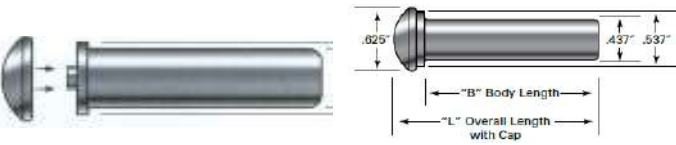

Pull Lock

316	Outdoor	Ø	Width	Overall length		⊠
PUL-4-2.030		1/8"	.537"	2.266"		1
PUL-6-2.030		3/16"	.537"	2.266"		1

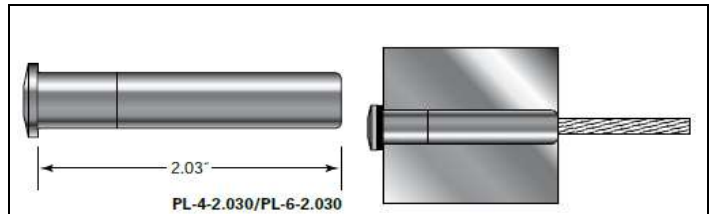

Push Lock

316	Outdoor	Ø	Width	length		⊠
PL-4-2.030		1/8"	.537"	2.03"		1
PL-6-2.030		3/16"	.537"	2.03"		1



Pull Lock Release Key

Plastic	Description		⊠
PL-Key	For 1/8" cables only		1



FOR PITCH OF	ORDER PART NO.
30° - 33°	BW32-6
34° - 36°	BW35-6
37° - 39°	BW38-6

Beveled Washer for Pitches

316	Outdoor	Ø	Pitch		⊠
BW32/35/38		1/8"	Specify		1
BW32/35/38		3/16"	Specify		1



TYPE 316 STAINLESS STEEL

Receiver Washer For Wood Posts

316	Outdoor	O.D.	I.D	Cable Diameter		⊠
WA7/16SAE		59/64"	15/32"	1/8" and 3/16"		1



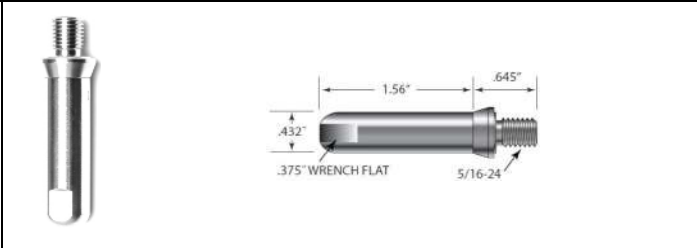

Push Lock Assembly, Face Mount Straight Run, Metal Attachment

316	Outdoor	Ø		
PL-FM-MS-4		1/8"		1
PL-FM-MS-6		3/16"		1

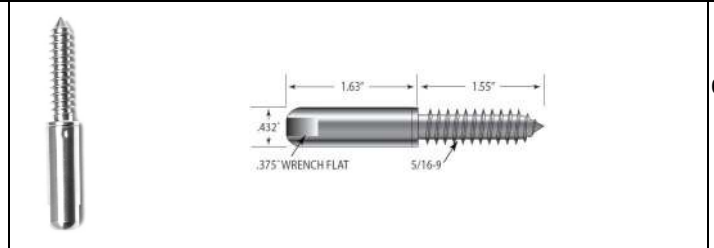

Push Lock Assembly with Fixed Lag, Wood Attachment

316	Outdoor	Ø		
PL-LAG-4		1/8"		1
PL-LAG-6		3/16"		1

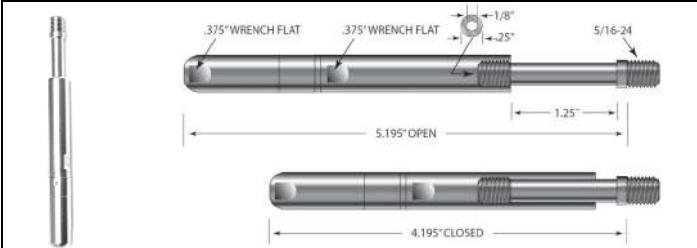

Tensioning Push Lock for Straight Run, Metal Attachment

316	Outdoor	Ø		
PL-SFC-MS-4		1/8"		1
PL-SFC-MS-6		3/16"		1

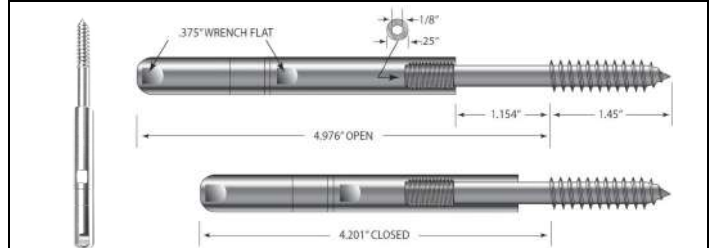

Tensioning Push Lock, Straight Run, Wood Attachment

316	Outdoor	Ø		
PL-SFC-WS-4		1/8"		1
PL-SFC-WS-6		3/16"		1

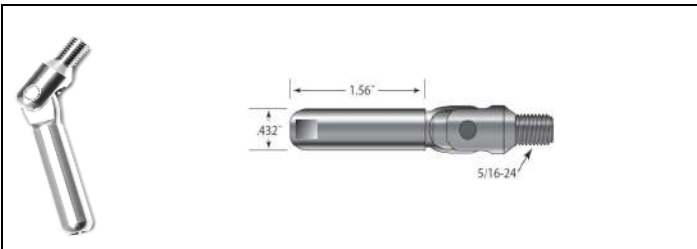

Push Lock Clevis/Threaded Eye Assembly, Metal Attachment

316	Outdoor	Ø		
PL-CL-RP-4		1/8"		1
PL-CL-RP-6		3/16"		1

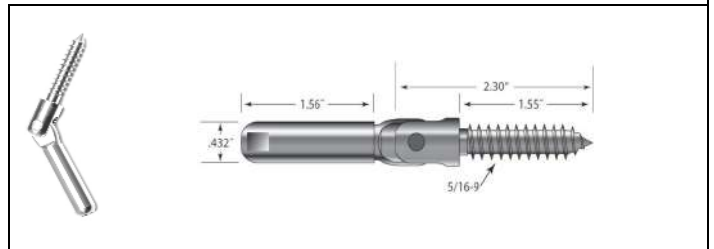

Push Lock Clevis/Threaded Eye Assembly, Wood Attachment

316	Outdoor	Ø		
PL-LAG-CL-TE4-1		1/8"		1
PL-LAG-CL-TE6-1		3/16"		1

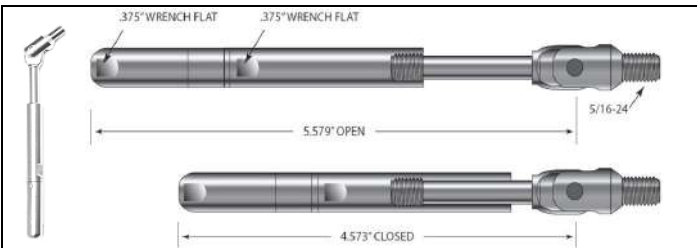

Tensioning Push Lock for Pitch, Metal Attachment

316	Outdoor	Ø		
PL-SFC-MP-4		1/8"		1
PL-SFC-MP-6		3/16"		1

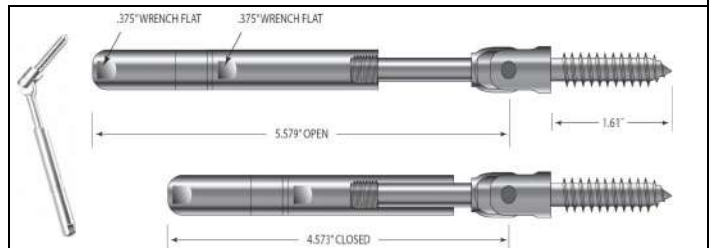

Tensioning Push Lock for Pitch, Wood Attachment

316	Outdoor	Ø		
PL-SFC-WP-4-1		1/8"		1
PL-SFC-WP-6-1		3/16"		1





Metric Hanger Bolts

316	Outdoor	Material	D	L		
93.0100.890.14		Stainless Steel	M8	3-1/2"	Wall bracket	1
93.0100.900.14		Stainless Steel	M10	6"	Barrel Clip	1



Hanger Bolt Kit for Post Mount

304	Indoor	Material	D	L		
Hanger Bolt - 1		Zinc or carbon steel	5/16"	3-1/2"		1
Hanger Bolt - 3		Zinc or carbon steel	3/8"	3-1/2"		1
316	Outdoor					
Hanger Bolt - 2		Stainless Steel	5/16"	3-1/2"		1
Hanger Bolt - 4		Stainless Steel	3/8"	3-1/2"		1

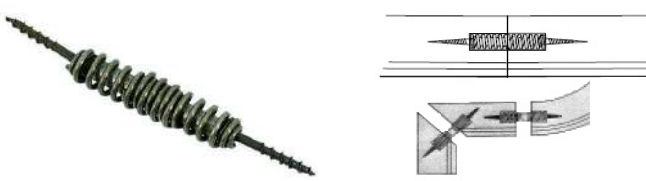

Spring Bolt

		Description	
Spring Bolt-1		Bolt for joining wood rails, Fully concealed	1

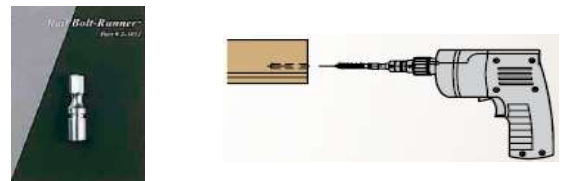

5/16" Rail Bolt Runner

		Description	
LJ-3032		For driving bolts into rail and into the floor	1



Screws for wood handrails

304	Indoor	Material	L	Type	drive	
13.#2PH.100		Stainless	1"	#8	#2	1

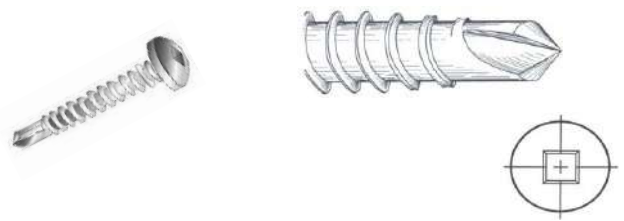

Screws for metal Handrails

Stainless Steel	Material	L	Type	drive	
13.#2SQ.075	Stainless	3/4"	#8-18	#2-Square	1



Glass Clamp Hardware (1 per clamp)

304	Indoor	Type	Type	
305053		5/16-18 x 3/4	Carbon Steel	1
316	Outdoor	Coarse Thread (USS) Button Socket Head Cap Screw		
336230		5/16-18 x 3/4	Stainless Steel	1



Rod Holder Hardware (1 per Holder)

304	Indoor	Type	Type	
315130		#10-32 x 1"	Carbon Steel	1
316	Outdoor			
336032		#10-32 x 1"	Stainless Steel	1



1.10 oz Metal Adhesive

Part Number		
19.32629		1



1.75 oz Loctite 7387 Activator

Part Number		
19.7387		1



Scotchbrite 3M Buffing pads

Part Number		
19.0640.000.00		1



Eclipse Glass Cleaner

Part Number		
80-703		1

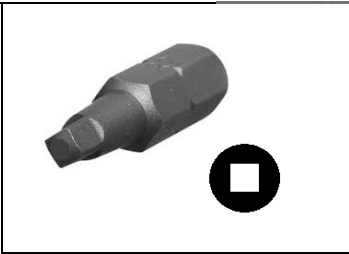

Phillips Square #2 Drive			
Size	Type		
1/4" Hex	Insert Bit		1



Phillips Standard #2 Drive			
Size	Type		
1/4" Hex	Insert Bit		1



Composite Tapered Wedge/Shim				
Part Number	L	W	H	
Wedge1	6"	1-1/2"	3/8"	1

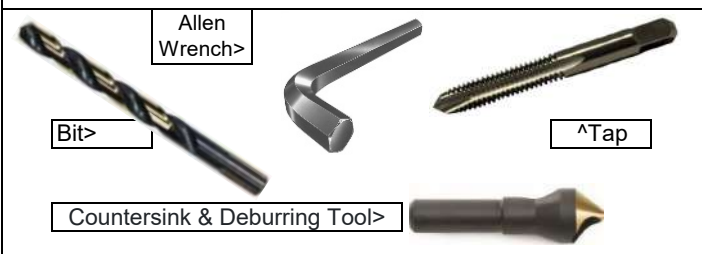

Drill Bits, Taps, Allen Wrenches				
Part Number	Size	Uses	Type	
83917	M2.5	For all set screws	Wrench	1
83919	M4.0	Misc	Wrench	1
83921	M6.0	Misc	Wrench	1
83922	M8.0	Misc	Wrench	1
83635	1/8	Rod Holder Hardware	Wrench	1
83638	3/16	Glass Clip Hardware	Wrench	1
83640	1/4	Misc	Wrench	1
83641	5/16	Misc	Wrench	1
82121	#21	Rod Holder Hardware	Bit	1
82509	9/64	Rail Screws	Bit	1
82107	#7	Misc	Bit	1
825121	3/16	1/8" Cable to pass through post	Bit	1
82516	1/4	3/16" Cable to pass through post	Bit	1
82520	5/16	Glass Clip Hardware	Bit	1
82524	3/8	Misc	Bit	1
82529	29/64	Cable Receiver Holes	Bit	1
823709	3/8-16	Misc	Tap	1
823788	5/16-18	Glass Clip Hardware	Tap	1
823884	#10-32	Rod Holder Hardware	Tap	1
823787	1/4-20	Misc	Tap	1
82642	5/16-3/4	Countersink & Deburring Tool	Beburr	1



Spandrel Wrench			
Part Number	Q	Ø	
19.0702.050.00	Q-32	1-3/4" - 2"	1
19.0702.060.00	Q-33	2-1/4" - 2-1/2"	1



Solv-All ULV™		
Part Number		
80-751		1



Steel Cleaner & Polish		
Part Number		
80-940		1

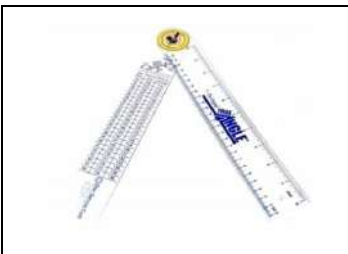

Angle Finder		
Part Number		
Angle.Finder		1



Hydraulic Pumps		
Name		
HYD Pump Air		1
HYD Pump ELE		1
Swager Head		1



Heavy duty Cable Cutter			
Part Number	Cable Cut Size	Length	
C-7	1/8" Cable Cutters	Light Duty (small)	1
C-9	3/16" Cable Cutters	Standard (medium)	1
C-12	1/4" Cable Cutters	Heavy Duty (Large)	1
C-16	3/8" Cable Cutters	Heavy Duty (Large)	1

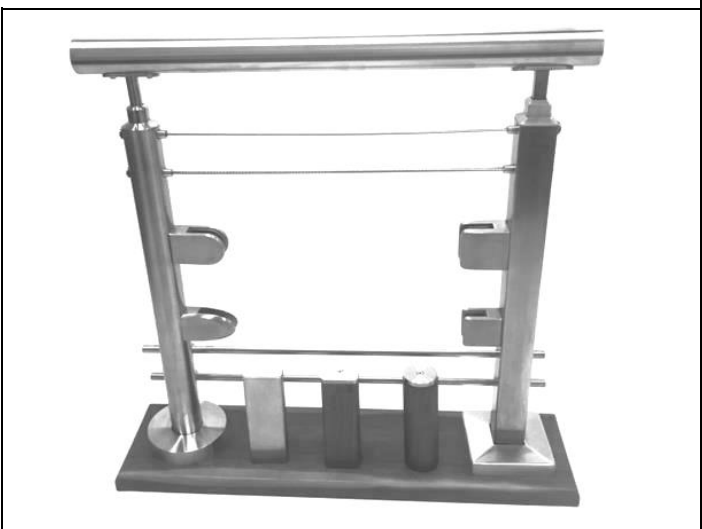

Display for Distributors		
Display	Description	
Display	Cable, Glass Clips, Rod, Square and Round.	1

If you do not already have Architectural drawings, use the example below to create your own floor plan drawing. Please include riser height, tread run and all measurements. Send us the drawing and quote request form found on page 30. (See Figure 2 for riser height and tread run explanation).

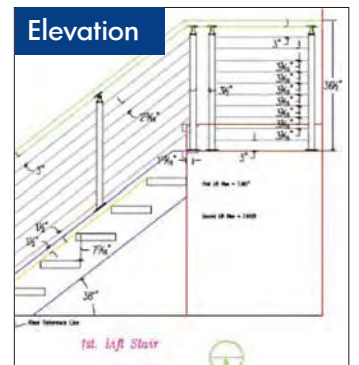
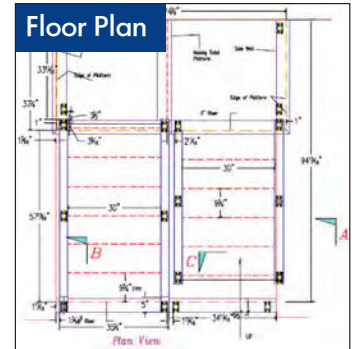
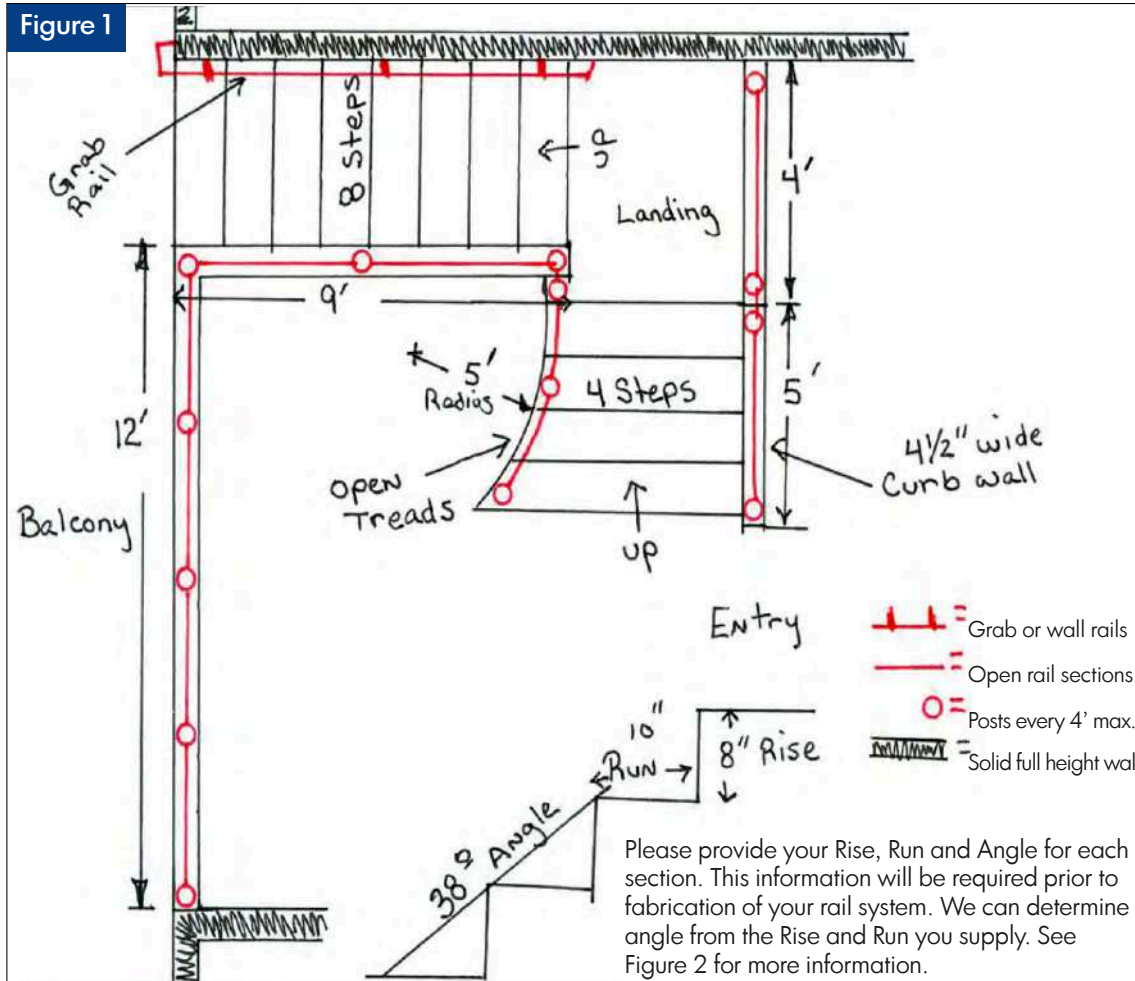

- | | | |
|-------------------|----------------------|----------------------------|
| 1. Rise _____ | 4. Total Rise _____ | 7. Rake Curb Height _____ |
| 2. Run _____ | 5. Total Run _____ | 8. Level Curb Height _____ |
| 3. Overhang _____ | 6. Rake Length _____ | 9. Curb Face Height _____ |

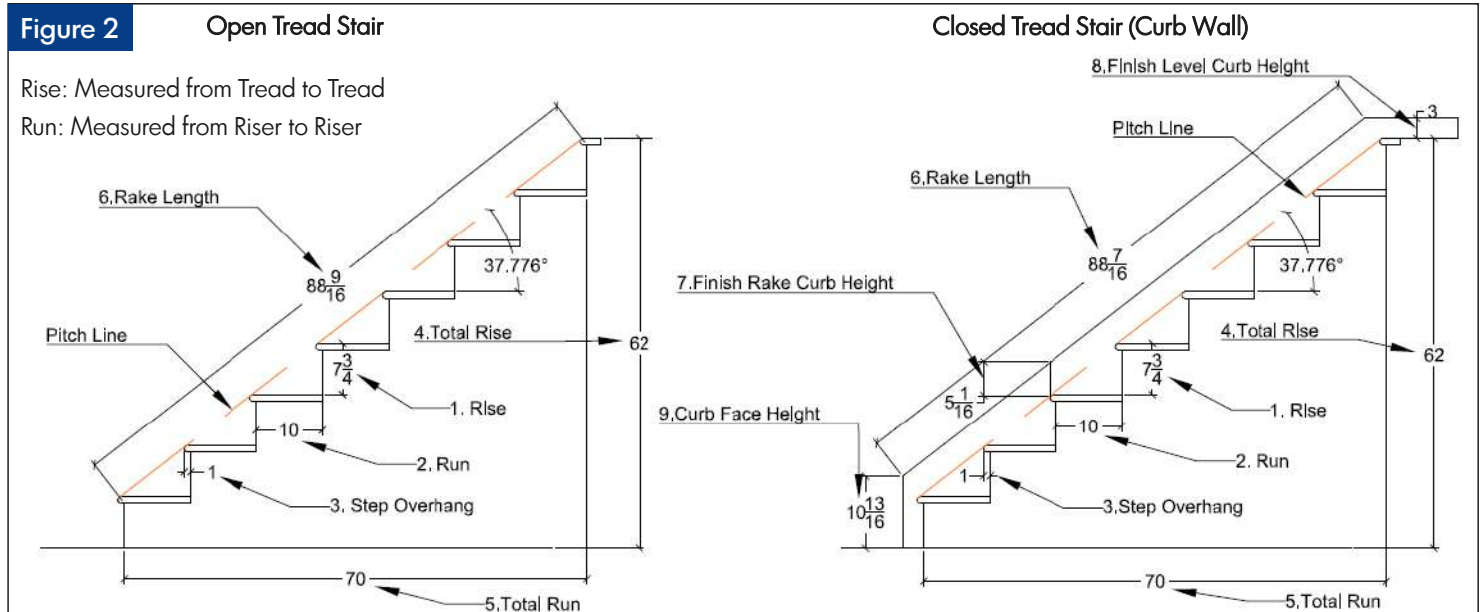

Railing System Quote Request Form

CONTACT INFORMATION

Name: _____ Sales Rep: _____
 Date: _____ Signature: _____

BILLING INFORMATION

Name: _____ Address: _____
 Address: _____ City: _____ State: _____ Zip: _____
 Phone Number: _____ Fax Number: _____
 E-mail Address: _____

PROJECT ADDRESS

Name: _____ Company: _____
 Address: _____ City: _____ State: _____ Zip: _____

PROJECT ADDRESS (CHECK ALL THAT APPLY)

Project Type	<input type="checkbox"/> Commercial	<input type="checkbox"/> Residential	<input type="checkbox"/> Interior	<input type="checkbox"/> Exterior
Project Location	<input type="checkbox"/> Main Stairway	<input type="checkbox"/> Secondary Stairway	<input type="checkbox"/> Balcony	<input type="checkbox"/> Deck
Comments: _____				
Mounting Surface	<input type="checkbox"/> Wood Deck	<input type="checkbox"/> Composite Deck	<input type="checkbox"/> Interior Wood	<input type="checkbox"/> Steel <input type="checkbox"/> Concrete
Support Post Mounting	<input type="checkbox"/> Top Mount	<input type="checkbox"/> Fascia Mount	<input type="checkbox"/> Welded	<input type="checkbox"/> Core Drilled
Please Describe: _____				
Drawing Submittal Format (Please include all measurements)	<input type="checkbox"/> Sketch	<input type="checkbox"/> Blueprints	<input type="checkbox"/> AutoCAD File	<input type="checkbox"/> PDF File

SYSTEM SPECIFICATIONS (CHECK ALL THAT APPLY)

Please Insert System Number		True View Glass TVG# _____	Secure View Cable SVC# _____	Defined Line DLH# _____
System Infill	Size Options	<input type="checkbox"/> Include Glass <input type="checkbox"/> 3/8" <input type="checkbox"/> 1/2"	<input type="checkbox"/> 1/8" <input type="checkbox"/> 3/16"	<input type="checkbox"/> 1/2" <input type="checkbox"/> 9/16" <input type="checkbox"/> 3/4"
	Glass Options	<input type="checkbox"/> Clear <input type="checkbox"/> Satin <input type="checkbox"/> Smoked		
Material Type				
Brushed Stainless Steel		<input type="checkbox"/>	<input type="checkbox"/>	<input type="checkbox"/>
Unfinished Carbon Steel		<input type="checkbox"/>	<input type="checkbox"/>	<input type="checkbox"/>
Wood Species (please specify)		_____	_____	_____
Balcony Height	<input type="checkbox"/> 36" <input type="checkbox"/> 42-1/4" <input type="checkbox"/> Other (please specify): _____			
Top Rail	<input type="checkbox"/> Stainless Steel <input type="checkbox"/> Carbon Steel <input type="checkbox"/> Other (please specify): _____			
Would you like us to perform the installation for you? <input type="checkbox"/> Yes, please <input type="checkbox"/> Please quote as an option <input type="checkbox"/> No, thank you				
Additional comments/questions: _____				

Save money by buying your glass locally. This eliminates CAD drawings, crating and shipping charges.

PLEASE SEND YOUR COMPLETED QUOTE REQUEST FORM ALONG WITH YOUR DRAWINGS TO:

Stair Service, Inc.
 255 Apollo Way, Suite A
 Hollister, CA 95023
 Toll Free: 800-940-1057
 Fax: 831-636-4860
 sales@stairservice.com

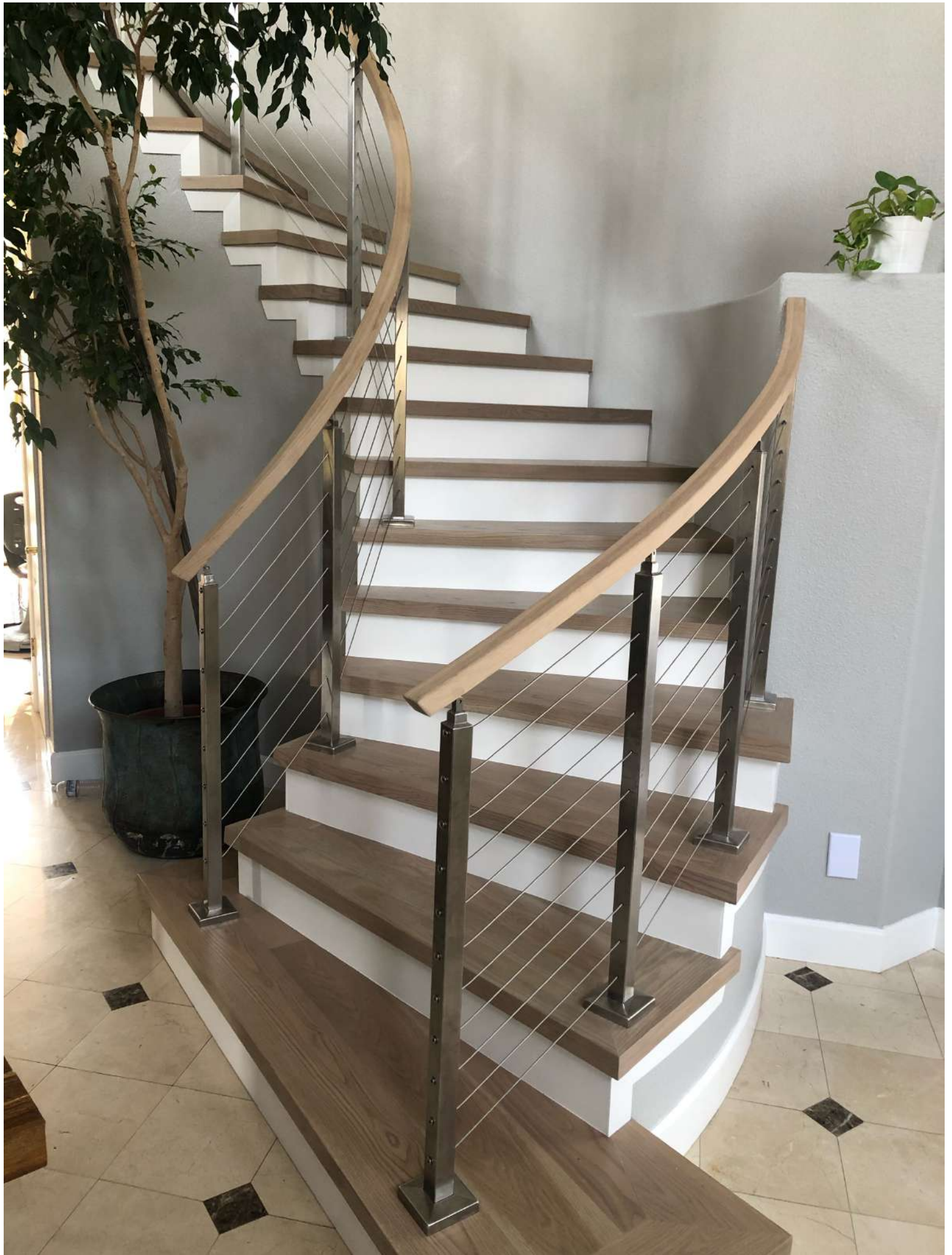

Toll Free: 800-478-2477

Distributed By:



www.stairservice.com
sales@stairservice.com

255 Apollo Way, Hollister CA 95023
Toll Free: 800-478-2477 • Fax: 408-920-0109

Connect with Us:

IMPORTANT NOTICE

All contents of this catalog, including logos, system and product images and descriptions are the sole property of Stair Service, Inc. The making and distribution of copies or reproduction of any of its content is strictly prohibited in any format. Exceptions, other than for consideration in purchasing products from Stair Service, Inc., and must be obtained in writing from the San Jose, California Headquarters.